

NUT SPLITTERS

HYDRAULIC - ENS

3/4" to 3-1/2" bolt diameter
M20 to M90



SINGLE ACTING



DOUBLE ACTING
Ideal for Subsea use

ENS HYDRAULIC NUT SPLITTER

Our hydraulic nut splitter offers a reliable and effective solution to the removal of seized and corroded nuts.

- Triple edge replaceable cutting blade
- Blade positioning scale to eliminate bolt damage
- Cutting depth fixed - Nut size adjustable via rotating cylinder!
- Size range from 3/4" to 3-1/2" bolt diameters
- Designed to fit ANSI, ASME B.16.5 flanges
 - Will work with some API flanges – contact factory for details
- Twin line hydraulic version available for subsea use
- Versatile, reliable and trouble-free operations
- Operates off a standard 10,000 psi (700 bar) pump unit
- Built-in safety relief valve to protect tool & operator

OK FOR SUBSEA



Double acting (subsea) version comes standard with 700 bar, 1/4" NPT, Push to Connect (PTC) couplers. To use with top side pumps, change out couplers to 700 bar, 1/4" NPT, Screw-to-connect style. See page 102 for coupler details.

Ordering Information

TO SPECIFY AN ENS SOLUTION:

1. Use the table located on the next page to identify the nut you need to split and select the appropriate head.
2. Select a single or double acting cylinder. For subsea applications only select double acting cylinders.
3. Order extra cutting blades (optional).

Accessory Ordering Information

Order No.	Description
ENSBL010001	Cutting blade for ENS1
ENSBL020001	Cutting blade for ENS2
ENSBL030001	Cutting blade for ENS3
ENSBL040001	Cutting blade for ENS4

Specifications and Dimensional Data

Pick One Cylinder +
One Head

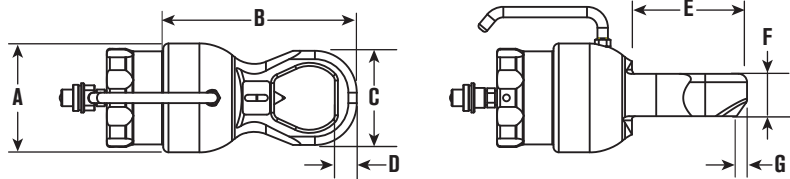

(Tool Reference) Order Numbers

STANDARD	OPTIONAL	Head	Bolt Dia.	Nut A/F	Bolt Dia.	Nut A/F	A		B		C		D		E		F		G		Wt			
			Imperial	in	Metric	mm	mm	in	mm	in	mm	in	mm	in	mm	in	mm	in	mm	in	kg	lb		
(ENS1) ENSAS010001	(ENS1) ENSAS010002	(ENS1-1) ENSAS010002	3/4"	1-1/4	M20	30	104	4.1	228	9.0	76	3.0	18	0.7	104	4.1	40.5	1.6	9	0.4	6.7	14.8		
			7/8"	1-7/16	M22	32																		
			1"	1-3/8	M24	36																		
					M27	41																		
		(ENS1-2) ENSAS010003	3/4"	1-1/4	M20	30	104	4.1	239	9.4	90	3.5	21	0.8	110	4.3	40.5	1.6	10	0.4	6.9	15.2		
			7/8"	1-7/16	M22	32																		
			1"	1-3/8	M24	36																		
			1-1/8"	1-13/16	M27	41																		
			1-1/4"	2	M30	46																		
					M33	50																		
(ENS2) ENSAS020001	(ENS2) ENSAS020004	(ENS2-1) ENSAS020002	1-1/8"	1-13/16	M30	46	138	5.4	305	12.0	102	4.0	22	0.9	132	5.2	57.5	2.3	6	0.2	15.8	34.8		
			1-1/4"	2	M33	50																		
			1-3/8"	2-3/16	M36	55																		
			1-1/2"	2-3/8	M39	60																		
		(ENS2-2) ENSAS020003	1-1/8"	1-13/16	M30	46	138	5.4	314	12.4	114	4.5	23	0.9	141	5.6	57.5	2.3	6	0.2	16	35.3		
			1-1/4"	2	M33	50																		
			1-3/8"	2-3/16	M36	55																		
			1-1/2"	2-3/8	M39	60																		
			1-5/8"	2-9/16	M42	65																		
			1-3/4"	2-3/4	M45	70																		
		(ENS3) ENSAS030001	(ENS3) ENSAS030006	(ENS3-1) ENSAS030002	1-3/4"	2-3/4	M45	70	190	7.5	406	16.0	132	5.2	28	1.1	189	7.4	80.5	3.2	8	0.3	42	92.6
					1-7/8"	2-15/16	M48	75																
					2"	3-1/8	M52	80																
				(ENS3-2) ENSAS030003	1-3/4"	2-3/4	M45	70	190	7.5	416	16.4	145	5.7	30	1.2	199	7.8	80.5	3.2	8	0.3	42.5	93.7
1-7/8"	2-15/16				M48	75																		
2"	3-1/8				M52	80																		
(ENS3-3) ENSAS030004	2-1/4"			3-1/2	M56	85	190	7.5	426	16.8	160	6.3	31.5	1.2	200	7.9	80.5	3.2	7	0.3	43	94.8		
	1-3/4"			2-3/4	M45	70																		
	1-7/8"			2-15/16	M48	75																		
	2"			3-1/8	M52	80																		
	2-1/4"			3-1/2	M56	85																		
	2-1/2"			3-7/8	M60	90																		
(ENS3-4) ENSAS030005				M64	95	190	7.5	437	17.2	174	6.9	35	1.4	204	8.0	80.5	3.2	9	0.4	44	97.0			
	1-3/4"			2-3/4	M45																	70		
	1-7/8"			2-15/16	M48																	75		
	2"			3-1/8	M52																	80		
	2-1/4"	3-1/2	M56	85																				
	2-1/2"	3-7/8	M60	90																				
	2-3/4"	4-1/4	M64	95																				
			M68	100																				
		M72	105																					
(ENS4) ENSAS040001	(ENS4) ENSAS040004	(ENS4-1) ENSAS040002	2-3/4"	4-1/4	M76	110	235	9.3	474	18.7	189	7.4	36.5	1.4	235	9.3	110.5	4.4	4	0.2	73	160.9		
			3"	4-5/8	M80	115																		
		(ENS4-2) ENSAS040003	2-3/4"	4-1/4	M76	110	235	9.3	495	19.5	219	8.6	41	1.6	240	9.4	110.5	4.4	3	0.1	75	165.3		
			3"	4-5/8	M80	115																		
			3-1/4"	5	M85	120																		
			3-1/2"	5-3/8	M90	130																		

Order a cylinder and a head to make complete nut splitter. Cylinders are interchangeable with heads within specific size ranges. Each are sold separately.