



“WORK SMARTER NOT HARDER”



Marcem Rentals are your North American
Techmine Distributor and Rental Partner. Contact
us today:

E: sales@marcem.ca Ph: +1 (825) 216-0382

PRODUCT CATALOGUE

ABOUT US

“WORK SMARTER NOT HARDER”

THAT IS THE VISION THAT UNDERPINS EVERYTHING WE DO AT TECHMINE SOLUTIONS. FOUNDED BY THREE ASSOCIATES WITH A SIMPLE VISION: TO CREATE A NEW GENERATION OF CONVEYOR BELT MAINTENANCE TOOLS TO REVOLUTIONALISE THE WAY BULK ROLLER CHANGEOUTS ARE CONDUCTED.

YEARS OF COMBINED EXPERIENCE IN MANAGING SITE CONSTRUCTION, FACILITATING BULK ROLLER CHANGE OUTS, AND MAINTAINING FIXED PLANT MACHINERY HAS ALLOWED TECHMINE SOLUTIONS TO PROVIDE SMART, ENGINEERED, AND CUSTOM SOLUTIONS TO MEET AND EXCEED THE DEMANDING REQUIREMENTS OF OUR CLIENTS.



OUR CLIENTS

PARTNERING WITH INDUSTRY LEADERS TO DELIVER INNOVATIVE SOLUTIONS.

The logo for BHP, consisting of the letters 'BHP' in a bold, orange, sans-serif font.The logo for RioTinto, featuring the name 'RioTinto' in white, sans-serif font centered within a solid red rectangular background.The logo for Teck, consisting of the word 'Teck' in a large, black, sans-serif font.The logo for Siemens, consisting of the word 'SIEMENS' in a bold, teal, sans-serif font.The logo for Blackwoods, consisting of the word 'Blackwoods' in white, sans-serif font centered within a solid blue rectangular background.



REGISTERED DESIGNS



INNOVATION THAT CHALLENGES THE STATUS QUO.



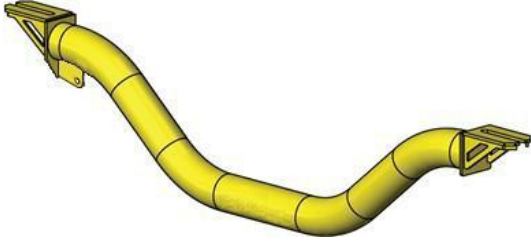

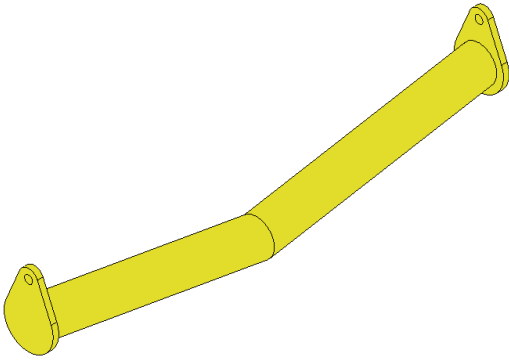
NEVER ONE TO SETTLE ON OUR LAURELS, TECHMINE SOLUTIONS' TEAM OF IN-HOUSE ENGINEERS HAVE CONTINUALLY PUSHED THE BOUNDARIES IN KEY AREAS OF SAFETY AND EFFICIENCY. SHOWCASED BELOW ARE A SELECTION OF OUR REGISTERED DESIGNS.

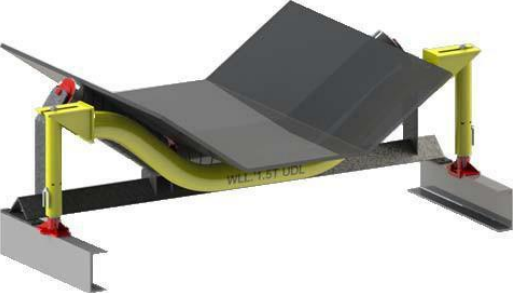

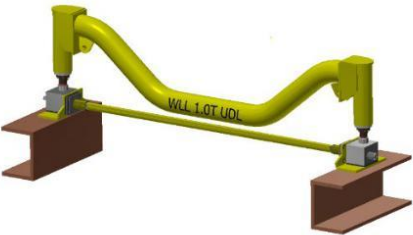

SECTION INDEX

	TROUGH LIFTING BEAMS	PAGES 6-20	
	OVERTROUGH LIFTING BEAMS	PAGES 21-27	
	TROUGH BEAM ON CHAINS	PAGES 28-41	
	V-BENT LIFTING BEAMS	PAGES 42-51	

	<p>FLAT LIFTING BEAMS</p>	<p>PAGES 52-62</p>	
	<p>HYDRAULIC BELT LIFTER</p>	<p>PAGES 63-65</p>	
	<p>HYDRAULIC POWER PACK</p>	<p>PAGES 66-67</p>	
	<p>TECHMINE AND ENERPAC CONVERTER</p>	<p>PAGES 68-69</p>	
	<p>MECHANICAL BELT LIFTER</p>	<p>PAGES 70-73</p>	

	<p>IDLER TRANSFER TOOL</p>	<p>PAGE 74</p>	
	<p>LIGHTWEIGHT ACCESS PLANK</p>	<p>PAGES 75-76</p>	
	<p>ADJUSTABLE LIFTING BEAM</p>	<p>PAGES 77-78</p>	
	<p>BELT LIFTING STATION</p>	<p>PAGES 79-80</p>	

	<p>IMPACT FRAME PIN PULLER</p>	<p>PAGE 81</p>	
	<p>ANTI-SLIP HYDRAULIC FOOT</p>	<p>PAGE 82</p>	
	<p>CUSTOM SOLUTIONS</p>	<p>PAGES 83-84</p>	

TROUGH LIFTING BEAMS

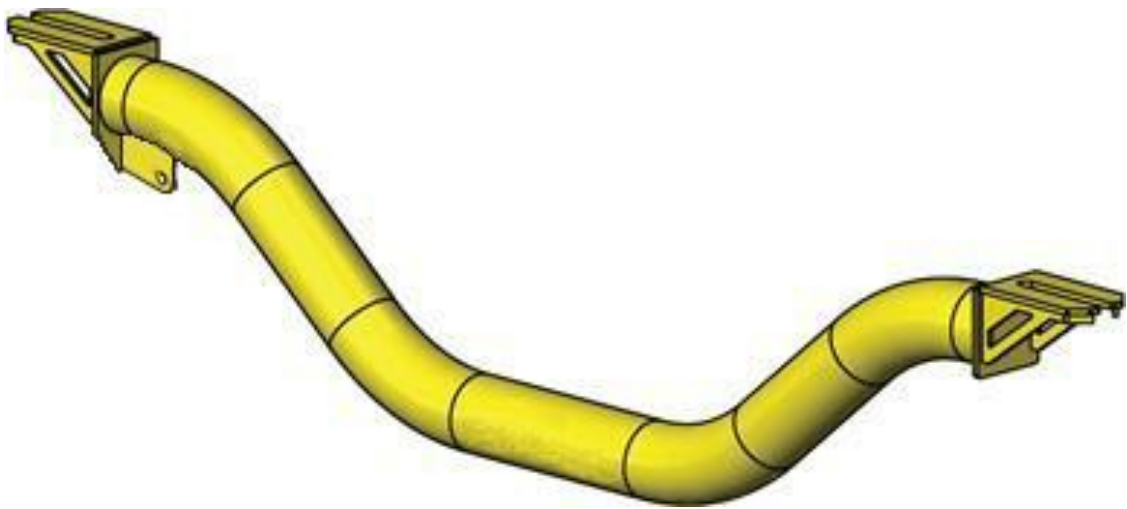

1T TROUGH LIFTING BEAMS

PART NUMBER	DETAILS	WEIGHT (KG)
TM-STB750	750MM LIFTING BEAM – 1T (WITH RETURN BELT LIFTING POINTS)	6.3
TM-STB900	900MM LIFTING BEAM – 1T (WITH RETURN BELT LIFTING POINTS)	6.5
TM-STB950	950MM LIFTING BEAM – 1T (WITH RETURN BELT LIFTING POINTS)	6.7
TM-STB1000	1000MM LIFTING BEAM – 1T (WITH RETURN BELT LIFTING POINTS)	6.9
TM-STB1050	1050MM LIFTING BEAM – 1T (WITH RETURN BELT LIFTING POINTS)	7.1
TM-STB1200	1200MM LIFTING BEAM – 1T (WITH RETURN BELT LIFTING POINTS)	7.7
TM-STB1250	1250MM LIFTING BEAM – 1T (WITH RETURN BELT LIFTING POINTS)	7.9
TM-STB1350	1350MM LIFTING BEAM – 1T (WITH RETURN BELT LIFTING POINTS)	8.1
TM-STB1400	1400MM LIFTING BEAM – 1T (WITH RETURN BELT LIFTING POINTS)	8.8
TM-STB1450	1450MM LIFTING BEAM – 1T (WITH RETURN BELT LIFTING POINTS)	9.2
TM-STB1500	1500MM LIFTING BEAM – 1T (WITH RETURN BELT LIFTING POINTS)	9.4
TM-STB1550	1550MM LIFTING BEAM – 1T (WITH RETURN BELT LIFTING POINTS)	9.6
TM-STB1600	1600MM LIFTING BEAM – 1T (WITH RETURN BELT LIFTING POINTS)	9.8
TM-STB1650	1650MM LIFTING BEAM – 1T (WITH RETURN BELT LIFTING POINTS)	10.0
TM-STB1800	1800MM LIFTING BEAM – 1T (WITH RETURN BELT LIFTING POINTS)	10.4
TM-STB1850	1850MM LIFTING BEAM – 1T (WITH RETURN BELT LIFTING POINTS)	10.6
TM-STB1900	1900MM LIFTING BEAM – 1T (WITH RETURN BELT LIFTING POINTS)	10.7
TM-STB2000	2000MM LIFTING BEAM – 1T (WITH RETURN BELT LIFTING POINTS)	11.0
TM-STB2050	2050MM LIFTING BEAM – 1T (WITH RETURN BELT LIFTING POINTS)	11.2
TM-STB2200	2200MM LIFTING BEAM – 1T (WITH RETURN BELT LIFTING POINTS)	11.4
TM-STB2250	2250MM LIFTING BEAM – 1T (WITH RETURN BELT LIFTING POINTS)	11.6
TM-STB2400	2400MM LIFTING BEAM – 1T (WITH RETURN BELT LIFTING POINTS)	11.8
TM-STB2450	2450MM LIFTING BEAM – 1T (WITH RETURN BELT LIFTING POINTS)	12.0
TM-STB2500	2500MM LIFTING BEAM – 1T (WITH RETURN BELT LIFTING POINTS)	12.2
TM-STB2600	2600MM LIFTING BEAM – 1T (WITH RETURN BELT LIFTING POINTS)	12.5

LIFTING BEAM DIMENSIONS

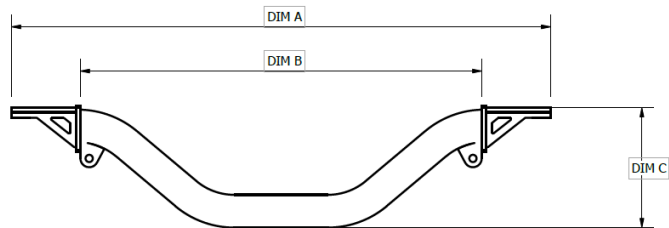

PART NUMBER	DIMENSION A (MM)	DIMENSION B (MM)	DIMENSION C (MM)
TM-STB750	1164	790	266
TM-STB900	1314	940	302
TM-STB950	1364	990	314
TM-STB1000	1414	1040	325
TM-STB1050	1464	1090	325
TM-STB1200	1614	1240	341
TM-STB1250	1664	1290	345
TM-STB1350	1764	1390	402
TM-STB1400	1814	1440	402
TM-STB1450	1864	1490	417
TM-STB1500	1914	1540	431
TM-STB1550	1964	1590	445
TM-STB1600	2014	1640	459
TM-STB1650	2064	1690	460
TM-STB1800	2214	1840	461
TM-STB1850	2264	1890	482
TM-STB1900	2314	1940	503
TM-STB2000	2414	2040	513
TM-STB2050	2464	2090	518
TM-STB2200	2614	2240	532
TM-STB2250	2664	2290	539
TM-STB2400	2814	2440	558
TM-STB2450	2864	2490	564
TM-STB2500	2914	2540	570
TM-STB2600	3014	2640	582

GENERAL ASSEMBLY DIMENSIONS

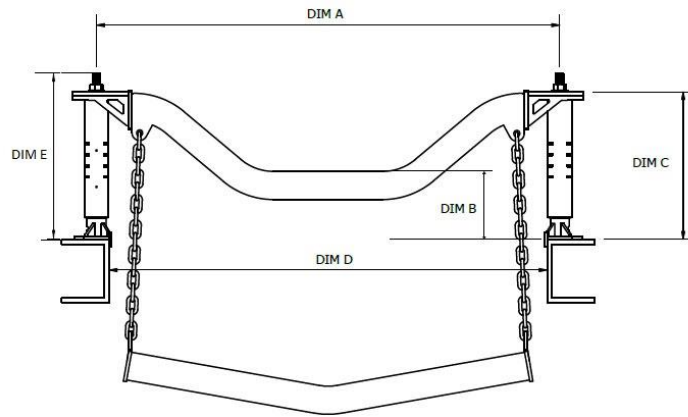

250MM TELESCOPE

PART NUMBER	DIM A (MIN)	DIM A (MAX)	DIM B (MIN)	DIM B (MAX)	DIM C (MIN)	DIM C (MAX)	DIM D (MIN)	DIM D (MAX)	DIM E (MIN)	DIM E (MAX)
TM-STB750	870	1090	293	543	470	720	815	985	529	779
TM-STB900	1020	1240	257	507	470	720	965	1135	529	779
TM-STB950	1070	1290	245	495	470	720	1015	1185	529	779
TM-STB1000	1120	1340	234	484	470	720	1065	1235	529	779
TM-STB1050	1170	1390	234	484	470	720	1115	1285	529	779
TM-STB1200	1320	1540	218	468	470	720	1265	1435	529	779
TM-STB1250	1370	1590	214	464	470	720	1315	1485	529	779
TM-STB1350	1470	1690	157	407	470	720	1415	1585	529	779
TM-STB1400	1520	1740	157	407	470	720	1465	1635	529	779
TM-STB1450	1570	1790	142	392	470	720	1515	1685	529	779
TM-STB1500	1620	1840	128	378	470	720	1565	1735	529	779
TM-STB1550	1670	1890	114	364	470	720	1615	1785	529	779

GENERAL ASSEMBLY DIMENSIONS

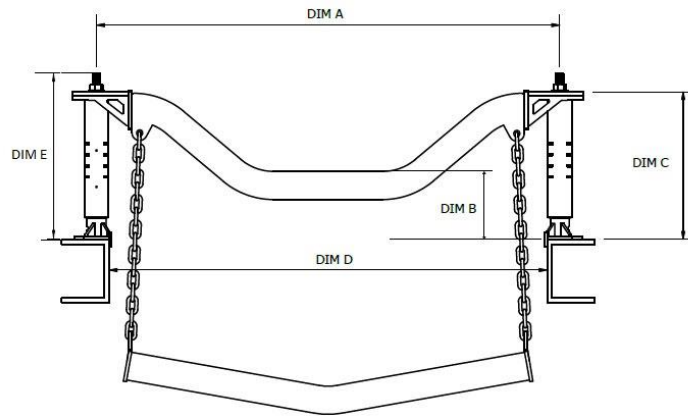

350MM TELESCOPE

PART NUMBER	DIM A (MIN)	DIM A (MAX)	DIM B (MIN)	DIM B (MAX)	DIM C (MIN)	DIM C (MAX)	DIM D (MIN)	DIM D (MAX)	DIM E (MIN)	DIM E (MAX)
TM-STB1600	1720	1940	200	550	570	920	1665	1835	644	994
TM-STB1650	1770	1990	199	549	570	920	1715	1885	644	994
TM-STB1800	1920	2140	198	548	570	920	1865	2035	644	994
TM-STB1850	1970	2190	177	527	570	920	1915	2085	644	994
TM-STB1900	2020	2240	156	506	570	920	1965	2135	644	994
TM-STB2000	2120	2340	146	496	570	920	2065	2235	644	994
TM-STB2050	2170	2390	141	491	570	920	2115	2285	644	994
TM-STB2200	2320	2540	127	477	570	920	2265	2435	644	994
TM-STB2250	2370	2590	120	470	570	920	2315	2485	644	994
TM-STB2400	2520	2740	101	451	570	920	2465	2635	644	994
TM-STB2450	2570	2790	95	445	570	920	2515	2685	644	994
TM-STB2500	2620	2840	89	439	570	920	2565	2735	644	994
TM-STB2600	2720	2940	77	427	570	920	2665	2835	644	994

NOTES

1. DIM B (MIN) AND DIM C (MIN) REFERS TO HEIGHT WHEN HYDRAULIC TELESCOPE IS AT MINIMUM EXTENSION.
2. DIM B (MAX) AND DIM C (MAX) REFERS TO HEIGHT WHEN HYDRAULIC TELESCOPE IS AT MAXIMUM EXTENSION.
3. 100MM AND 150MM EXTENSIONS ARE AVAILABLE FOR BEAMS TM-STB2000 AND ABOVE.
4. PLEASE USE GENERAL ASSEMBLY DIMENSION GUIDE IN CONJUNCTION WITH TECHMINE QUESTIONNAIRE SHEET

1.5T TROUGH LIFTING BEAMS

PART NUMBER	DETAILS	WEIGHT (KG)
TM-LTB750	750MM LIFTING BEAM – 1.5T (WITH RETURN BELT LIFTING POINTS)	6.3
TM-LTB900	900MM LIFTING BEAM – 1.5T (WITH RETURN BELT LIFTING POINTS)	6.5
TM-LTB950	950MM LIFTING BEAM – 1.5T (WITH RETURN BELT LIFTING POINTS)	6.7
TM-LTB1000	1000MM LIFTING BEAM – 1.5T (WITH RETURN BELT LIFTING POINTS)	6.9
TM-LTB1050	1050MM LIFTING BEAM – 1.5T (WITH RETURN BELT LIFTING POINTS)	7.1
TM-LTB1200	1200MM LIFTING BEAM – 1.5T (WITH RETURN BELT LIFTING POINTS)	7.7
TM-LTB1250	1250MM LIFTING BEAM – 1.5T (WITH RETURN BELT LIFTING POINTS)	7.9
TM-LTB1350	1350MM LIFTING BEAM – 1.5T (WITH RETURN BELT LIFTING POINTS)	8.1
TM-LTB1400	1400MM LIFTING BEAM – 1.5T (WITH RETURN BELT LIFTING POINTS)	8.8
TM-LTB1450	1450MM LIFTING BEAM – 1.5T (WITH RETURN BELT LIFTING POINTS)	9.2
TM-LTB1500	1500MM LIFTING BEAM – 1.5T (WITH RETURN BELT LIFTING POINTS)	9.4
TM-LTB1550	1550MM LIFTING BEAM – 1.5T (WITH RETURN BELT LIFTING POINTS)	9.6
TM-LTB1600	1600MM LIFTING BEAM – 1.5T (WITH RETURN BELT LIFTING POINTS)	12.7
TM-LTB1650	1650MM LIFTING BEAM – 1.5T (WITH RETURN BELT LIFTING POINTS)	13.2
TM-LTB1800	1800MM LIFTING BEAM – 1.5T (WITH RETURN BELT LIFTING POINTS)	15.3
TM-LTB1850	1850MM LIFTING BEAM – 1.5T (WITH RETURN BELT LIFTING POINTS)	15.7
TM-LTB2000	2000MM LIFTING BEAM – 1.5T (WITH RETURN BELT LIFTING POINTS)	16.6
TM-LTB2050	2050MM LIFTING BEAM – 1.5T (WITH RETURN BELT LIFTING POINTS)	17.1
TM-LTB2200	2200MM LIFTING BEAM – 1.5T (WITH RETURN BELT LIFTING POINTS)	18.0
TM-LTB2250	2250MM LIFTING BEAM – 1.5T (WITH RETURN BELT LIFTING POINTS)	18.3
TM-LTB2400	2400MM LIFTING BEAM – 1.5T (WITH RETURN BELT LIFTING POINTS)	19.0
TM-LTB2450	2450MM LIFTING BEAM – 1.5T (WITH RETURN BELT LIFTING POINTS)	19.2
TM-LTB2500	2500MM LIFTING BEAM – 1.5T (WITH RETURN BELT LIFTING POINTS)	19.4
TM-LTB2600	2600MM LIFTING BEAM – 1.5T (WITH RETURN BELT LIFTING POINTS)	19.8

LIFTING BEAM DIMENSIONS

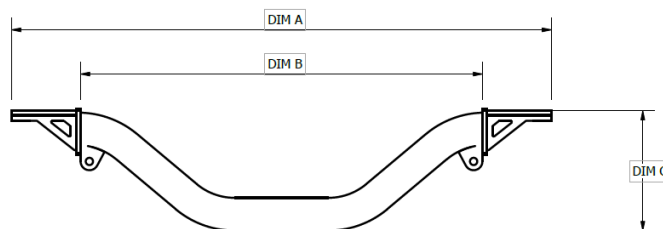

PART NUMBER	DIMENSION A (MM)	DIMENSION B (MM)	DIMENSION C (MM)
TM-LTB750	1164	790	266
TM-LTB900	1314	940	302
TM-LTB950	1364	990	314
TM-LTB1000	1414	1040	325
TM-LTB1050	1464	1090	325
TM-LTB1200	1614	1240	341
TM-LTB1250	1664	1290	345
TM-LTB1350	1764	1390	402
TM-LTB1400	1814	1440	402
TM-LTB1450	1864	1490	417
TM-LTB1500	1914	1540	431
TM-LTB1550	1964	1590	445
TM-LTB1600	2014	1640	459
TM-LTB1650	2154	1690	504
TM-LTB1800	2304	1840	504
TM-LTB1850	2354	1890	515
TM-LTB2000	2464	2040	564
TM-LTB2050	2554	2090	554
TM-LTB2200	2704	2240	575
TM-LTB2250	2754	2290	582
TM-LTB2400	2904	2440	601
TM-LTB2450	2954	2490	607
TM-LTB2500	3004	2540	613
TM-LTB2600	3104	2640	627

GENERAL ASSEMBLY DIMENSIONS

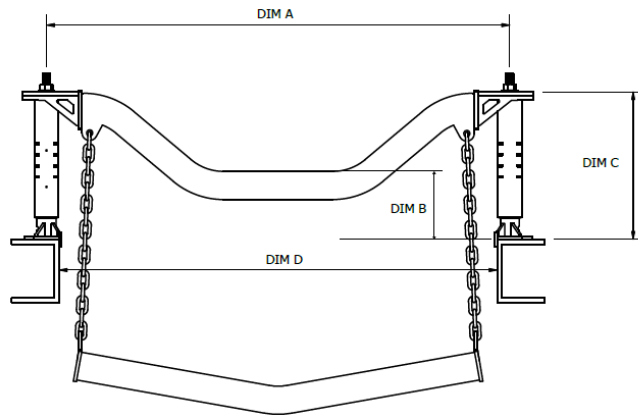

250MM TELESCOPE

PART NUMBER	DIM A (MIN)	DIM A (MAX)	DIM B (MIN)	DIM B (MAX)	DIM C (MIN)	DIM C (MAX)	DIM D (MIN)	DIM D (MAX)	DIM E (MIN)	DIM E (MAX)
TM-LTB750	870	1090	293	543	470	720	815	985	529	779
TM-LTB900	1020	1240	257	507	470	720	965	1135	529	779
TM-LTB950	1070	1290	245	495	470	720	1015	1185	529	779
TM-LTB1000	1120	1340	234	484	470	720	1065	1235	529	779
TM-LTB1050	1170	1390	234	484	470	720	1115	1285	529	779
TM-LTB1200	1320	1540	218	468	470	720	1265	1435	529	779
TM-LTB1250	1370	1590	214	464	470	720	1315	1485	529	779
TM-LTB1350	1470	1690	157	407	470	720	1415	1585	529	779
TM-LTB1400	1520	1740	157	407	470	720	1465	1635	529	779
TM-LTB1450	1570	1790	142	392	470	720	1515	1685	529	779
TM-LTB1500	1620	1840	128	378	470	720	1565	1735	529	779
TM-LTB1550	1670	1890	114	364	470	720	1615	1785	529	779

GENERAL ASSEMBLY DIMENSIONS

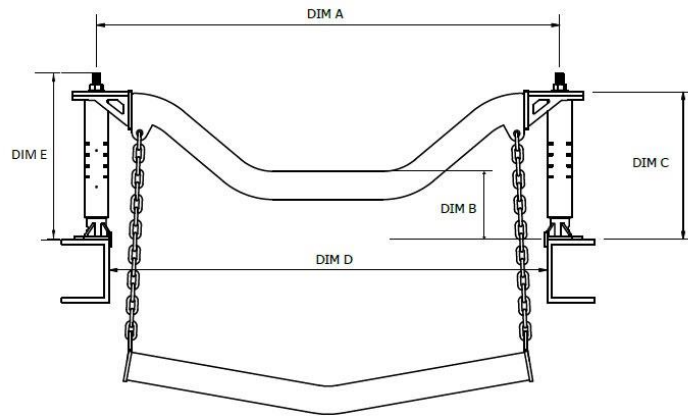

350MM TELESCOPE

PART NUMBER	DIM A (MIN)	DIM A (MAX)	DIM B (MIN)	DIM B (MAX)	DIM C (MIN)	DIM C (MAX)	DIM D (MIN)	DIM D (MAX)	DIM E (MIN)	DIM E (MAX)
TM-LTB1600	1690	1950	238	588	570	920	1665	1835	644	994
TM-LTB1650	1740	2000	193	543	570	920	1715	1885	644	994
TM-LTB1800	1890	2150	193	543	570	920	1865	2035	644	994
TM-LTB1850	1940	2200	182	532	570	920	1915	2085	644	994
TM-LTB2000	2090	2350	133	483	570	920	2065	2235	644	994
TM-LTB2050	2140	2400	143	493	570	920	2115	2285	644	994
TM-LTB2200	2290	2550	122	472	570	920	2265	2435	644	994
TM-LTB2250	2340	2600	115	465	570	920	2315	2485	644	994
TM-LTB2400	2490	2750	96	446	570	920	2465	2635	644	994
TM-LTB2450	2540	2800	90	440	570	920	2515	2685	644	994
TM-LTB2500	2590	2850	84	434	570	920	2565	2735	644	994
TM-LTB2600	2690	2950	70	420	570	920	2665	2835	644	994

NOTES

- DIM B (MIN) AND DIM C (MIN) REFERS TO HEIGHT WHEN HYDRAULIC TELESCOPE IS AT MINIMUM EXTENSION.
- DIM B (MAX) AND DIM C (MAX) REFERS TO HEIGHT WHEN HYDRAULIC TELESCOPE IS AT MAXIMUM EXTENSION.
- 100MM AND 150MM EXTENSIONS ARE AVAILABLE FOR BEAMS TM-LTB2000 AND ABOVE.
- PLEASE USE GENERAL ASSEMBLY DIMENSION GUIDE IN CONJUNCTION WITH TECHMINE QUESTIONNAIRE SHEET

2T TROUGH LIFTING BEAMS

PART NUMBER	DETAILS	WEIGHT (KG)
TM-XTB750	750MM LIFTING BEAM – 2T (WITH RETURN BELT LIFTING POINTS)	6.3
TM-XTB900	900MM LIFTING BEAM – 2T (WITH RETURN BELT LIFTING POINTS)	6.5
TM-XTB950	950MM LIFTING BEAM – 2T (WITH RETURN BELT LIFTING POINTS)	6.7
TM-XTB1000	1000MM LIFTING BEAM – 2T (WITH RETURN BELT LIFTING POINTS)	6.9
TM-XTB1050	1050MM LIFTING BEAM – 2T (WITH RETURN BELT LIFTING POINTS)	7.1
TM-XTB1200	1200MM LIFTING BEAM – 2T (WITH RETURN BELT LIFTING POINTS)	7.7
TM-XTB1250	1250MM LIFTING BEAM – 2T (WITH RETURN BELT LIFTING POINTS)	7.9
TM-XTB1350	1350MM LIFTING BEAM – 2T (WITH RETURN BELT LIFTING POINTS)	8.1
TM-XTB1400	1400MM LIFTING BEAM – 2T (WITH RETURN BELT LIFTING POINTS)	8.8
TM-XTB1450	1450MM LIFTING BEAM – 2T (WITH RETURN BELT LIFTING POINTS)	9.2
TM-XTB1500	1500MM LIFTING BEAM – 2T (WITH RETURN BELT LIFTING POINTS)	9.4
TM-XTB1550	1550MM LIFTING BEAM – 2T (WITH RETURN BELT LIFTING POINTS)	9.6
TM-XTB1600	1600MM LIFTING BEAM – 2T (WITH RETURN BELT LIFTING POINTS)	12.7
TM-XTB1650	1650MM LIFTING BEAM – 2T (WITH RETURN BELT LIFTING POINTS)	13.2
TM-XTB1800	1800MM LIFTING BEAM – 2T (WITH RETURN BELT LIFTING POINTS)	15.3
TM-XTB1850	1850MM LIFTING BEAM – 2T (WITH RETURN BELT LIFTING POINTS)	15.7
TM-XTB2000	2000MM LIFTING BEAM – 2T (WITH RETURN BELT LIFTING POINTS)	16.6
TM-XTB2050	2050MM LIFTING BEAM – 2T (WITH RETURN BELT LIFTING POINTS)	17.1
TM-XTB2200	2200MM LIFTING BEAM – 2T (WITH RETURN BELT LIFTING POINTS)	18.0
TM-XTB2250	2250MM LIFTING BEAM – 2T (WITH RETURN BELT LIFTING POINTS)	18.3
TM-XTB2400	2400MM LIFTING BEAM – 2T (WITH RETURN BELT LIFTING POINTS)	19.0
TM-XTB2450	2450MM LIFTING BEAM – 2T (WITH RETURN BELT LIFTING POINTS)	19.2
TM-XTB2500	2500MM LIFTING BEAM – 2T (WITH RETURN BELT LIFTING POINTS)	19.4
TM-XTB2600	2600MM LIFTING BEAM – 2T (WITH RETURN BELT LIFTING POINTS)	19.8
TM-XTB2700	2700MM LIFTING BEAM – 2T (WITH RETURN BELT LIFTING POINTS)	20.2
TM-XTB3000	3000MM LIFTING BEAM – 2T (WITH RETURN BELT LIFTING POINTS)	21.4

LIFTING BEAM DIMENSIONS

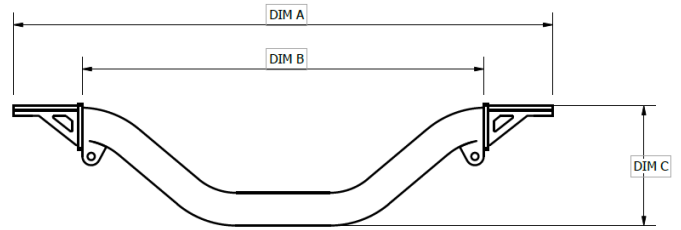

PART NUMBER	DIMENSION A (MM)	DIMENSION B (MM)	DIMENSION C (MM)
TM-XTB750	1164	790	266
TM-XTB900	1314	940	302
TM-XTB950	1364	990	314
TM-XTB1000	1414	1040	325
TM-XTB1050	1464	1090	325
TM-XTB1200	1614	1240	341
TM-XTB1250	1664	1290	345
TM-XTB1350	1764	1390	402
TM-XTB1400	1814	1440	402
TM-XTB1450	1864	1490	417
TM-XTB1500	1914	1540	431
TM-XTB1550	1964	1590	445
TM-XTB1600	2014	1640	459
TM-XTB1650	2154	1690	504
TM-XTB1800	2304	1840	504
TM-XTB1850	2354	1890	515
TM-XTB2000	2464	2040	564
TM-XTB2050	2554	2090	554
TM-XTB2200	2704	2240	575
TM-XTB2250	2754	2290	582
TM-XTB2400	2904	2440	601
TM-XTB2450	2954	2490	607
TM-XTB2500	3004	2540	613
TM-XTB2600	3104	2640	627
TM-XTB2700	3204	2740	-
TM-XTB3000	3504	3040	-

GENERAL ASSEMBLY DIMENSIONS

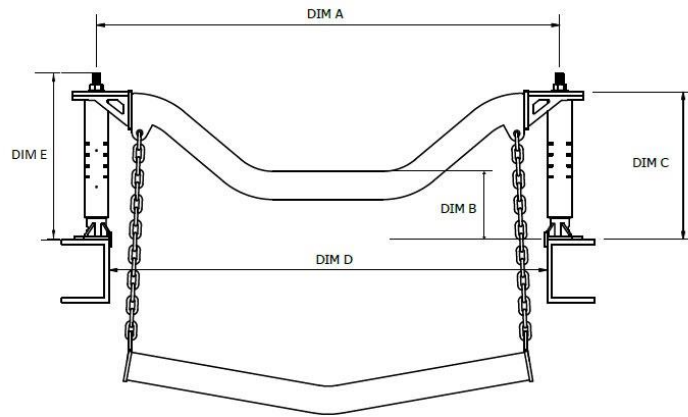

250MM TELESCOPE

PART NUMBER	DIM A (MIN)	DIM A (MAX)	DIM B (MIN)	DIM B (MAX)	DIM C (MIN)	DIM C (MAX)	DIM D (MIN)	DIM D (MAX)	DIM E (MIN)	DIM E (MAX)
TM-XTB750	870	1090	293	543	470	720	815	985	529	779
TM-XTB900	1020	1240	257	507	470	720	965	1135	529	779
TM-XTB950	1070	1290	245	495	470	720	1015	1185	529	779
TM-XTB1000	1120	1340	234	484	470	720	1065	1235	529	779
TM-XTB1050	1170	1390	234	484	470	720	1115	1285	529	779
TM-XTB1200	1320	1540	218	468	470	720	1265	1435	529	779
TM-XTB1250	1370	1590	214	464	470	720	1315	1485	529	779
TM-XTB1350	1470	1690	157	407	470	720	1415	1585	529	779
TM-XTB1400	1520	1740	157	407	470	720	1465	1635	529	779
TM-XTB1450	1570	1790	142	392	470	720	1515	1685	529	779
TM-XTB1500	1620	1840	128	378	470	720	1565	1735	529	779
TM-XTB1550	1670	1890	114	364	470	720	1615	1785	529	779

GENERAL ASSEMBLY DIMENSIONS

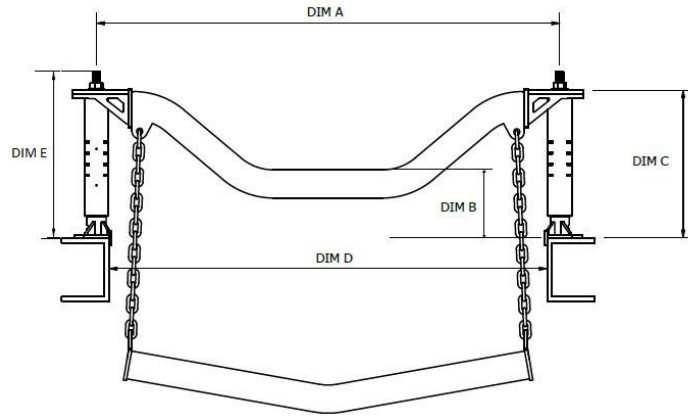

350MM TELESCOPE

PART NUMBER	DIM A (MIN)	DIM A (MAX)	DIM B (MIN)	DIM B (MAX)	DIM C (MIN)	DIM C (MAX)	DIM D (MIN)	DIM D (MAX)	DIM E (MIN)	DIM E (MAX)
TM-XTB1600	1690	1950	238	588	570	920	1665	1835	644	994
TM-XTB1650	1740	2000	193	543	570	920	1715	1885	644	994
TM-XTB1800	1890	2150	193	543	570	920	1865	2035	644	994
TM-XTB1850	1940	2200	182	532	570	920	1915	2085	644	994
TM-XTB2000	2090	2350	133	483	570	920	2065	2235	644	994
TM-XTB2050	2140	2400	143	493	570	920	2115	2285	644	994
TM-XTB2200	2290	2550	122	472	570	920	2265	2435	644	994
TM-XTB2250	2340	2600	115	465	570	920	2315	2485	644	994
TM-XTB2400	2490	2750	96	446	570	920	2465	2635	644	994
TM-XTB2450	2540	2800	90	440	570	920	2515	2685	644	994
TM-XTB2500	2590	2850	84	434	570	920	2565	2735	644	994
TM-XTB2600	2690	2950	70	420	570	920	2665	2835	644	994
TM-XTB2700	2790	3050	-	-	570	920	2765	2935	644	994
TM-XTB3000	3090	3350	-	-	570	920	3065	3235	644	994

NOTES

- DIM B (MIN) AND DIM C (MIN) REFERS TO HEIGHT WHEN HYDRAULIC TELESCOPE IS AT MINIMUM EXTENSION.
- DIM B (MAX) AND DIM C (MAX) REFERS TO HEIGHT WHEN HYDRAULIC TELESCOPE IS AT MAXIMUM EXTENSION.
- 100MM AND 150MM EXTENSIONS ARE AVAILABLE FOR BEAMS TM-XTB2000 AND ABOVE.
- PLEASE USE GENERAL ASSEMBLY DIMENSION GUIDE IN CONJUNCTION WITH TECHMINE QUESTIONNAIRE SHEET

OVERTROUGH LIFTING BEAMS



1T OVERTROUGH LIFTING BEAMS

PART NUMBER	DETAILS	WEIGHT (KG)
TM-OTS900	900MM LIFTING BEAM – 1T (WITH RETURN BELT LIFTING POINTS)	3.6
TM-OTS1050	1050MM LIFTING BEAM – 1T (WITH RETURN BELT LIFTING POINTS)	4.1
TM-OTS1200	1200MM LIFTING BEAM – 1T (WITH RETURN BELT LIFTING POINTS)	4.7
TM-OTS1350	1350MM LIFTING BEAM – 1T (WITH RETURN BELT LIFTING POINTS)	5.3
TM-OTS1400	1400MM LIFTING BEAM – 1T (WITH RETURN BELT LIFTING POINTS)	5.4
TM-OTS1500	1500MM LIFTING BEAM – 1T (WITH RETURN BELT LIFTING POINTS)	5.8
TM-OTS1600	1600MM LIFTING BEAM – 1T (WITH RETURN BELT LIFTING POINTS)	6.2
TM-OTS1800	1800MM LIFTING BEAM – 1T (WITH RETURN BELT LIFTING POINTS)	7.0
TM-OTS2000	2000MM LIFTING BEAM – 1T (WITH RETURN BELT LIFTING POINTS)	7.7
TM-OTSCUST	CUSTOM LIFTING BEAM – 1T (WITH RETURN BELT LIFTING POINTS)	-

LIFTING BEAM DIMENSIONS

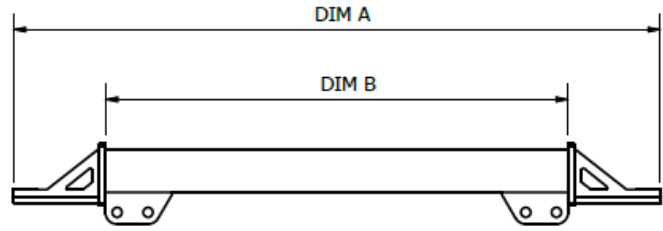

PART NUMBER	DIMENSION A	DIMENSION B
TM-OTS900	1314	940
TM-OTS1050	1464	1090
TM-OTS1200	1614	1240
TM-OTS1350	1764	1390
TM-OTS1400	1814	1440
TM-OTS1500	1914	1540
TM-OTS1600	2014	1640
TM-OTS1800	2214	1840
TM-OTS2000	2414	2040
TM-OTSCUST	CUSTOM	CUSTOM

1.5T OVERTROUGH LIFTING BEAMS

PART NUMBER	DETAILS	WEIGHT (KG)
TM-OTL900	900MM LIFTING BEAM – 1.5T (WITH RETURN BELT LIFTING POINTS)	3.6
TM-OTL1050	1050MM LIFTING BEAM – 1.5T (WITH RETURN BELT LIFTING POINTS)	4.1
TM-OTL1200	1200MM LIFTING BEAM – 1.5T (WITH RETURN BELT LIFTING POINTS)	4.7
TM-OTL1350	1350MM LIFTING BEAM – 1.5T (WITH RETURN BELT LIFTING POINTS)	5.3
TM-OTL1400	1400MM LIFTING BEAM – 1.5T (WITH RETURN BELT LIFTING POINTS)	5.4
TM-OTL1500	1500MM LIFTING BEAM – 1.5T (WITH RETURN BELT LIFTING POINTS)	5.8
TM-OTL1600	1600MM LIFTING BEAM – 1.5T (WITH RETURN BELT LIFTING POINTS)	6.2
TM-OTL1650	1650MM LIFTING BEAM – 1.5T (WITH RETURN BELT LIFTING POINTS)	6.4
TM-OTL1800	1800MM LIFTING BEAM – 1.5T (WITH RETURN BELT LIFTING POINTS)	7.0
TM-OTL2000	2000MM LIFTING BEAM – 1.5T (WITH RETURN BELT LIFTING POINTS)	7.7
TM-OTL2200	2200MM LIFTING BEAM – 1.5T (WITH RETURN BELT LIFTING POINTS)	8.5
TM-OTLCUST	CUSTOM LIFTING BEAM – 1.5T (WITH RETURN BELT LIFTING POINTS)	-

LIFTING BEAM DIMENSIONS

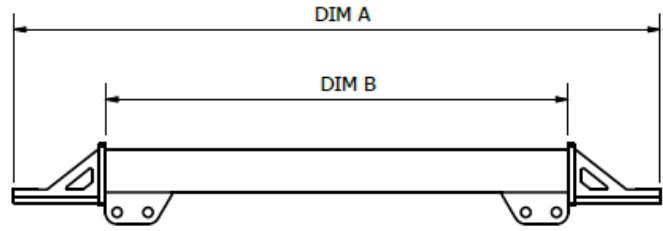

PART NUMBER	DIMENSION A	DIMENSION B
TM-OTL900	1314	940
TM-OTL1050	1464	1090
TM-OTL1200	1614	1240
TM-OTL1350	1764	1390
TM-OTL1400	1814	1440
TM-OTL1500	1914	1540
TM-OTL1600	2014	1640
TM-OTL1650	2064	1690
TM-OTL1800	2214	1840
TM-OTL2000	2414	2040
TM-OTL2200	2614	2240
TM-OTLCUST	CUSTOM	CUSTOM

2T OVERTROUGH LIFTING BEAMS

PART NUMBER	DETAILS	WEIGHT (KG)
TM-OTX900	900MM LIFTING BEAM – 2T (WITH RETURN BELT LIFTING POINTS)	4.7
TM-OTX1050	1050MM LIFTING BEAM – 2T (WITH RETURN BELT LIFTING POINTS)	5.4
TM-OTX1200	1200MM LIFTING BEAM – 2T (WITH RETURN BELT LIFTING POINTS)	6.2
TM-OTX1350	1350MM LIFTING BEAM – 2T (WITH RETURN BELT LIFTING POINTS)	6.9
TM-OTX1400	1400MM LIFTING BEAM – 2T (WITH RETURN BELT LIFTING POINTS)	7.2
TM-OTX1500	1500MM LIFTING BEAM – 2T (WITH RETURN BELT LIFTING POINTS)	7.7
TM-OTX1550	1550MM LIFTING BEAM – 2T (WITH RETURN BELT LIFTING POINTS)	7.9
TM-OTX1600	1600MM LIFTING BEAM – 2T (WITH RETURN BELT LIFTING POINTS)	8.2
TM-OTX1700	1700MM LIFTING BEAM – 2T (WITH RETURN BELT LIFTING POINTS)	8.7
TM-OTX1800	1800MM LIFTING BEAM – 2T (WITH RETURN BELT LIFTING POINTS)	9.2
TM-OTX2000	2000MM LIFTING BEAM – 2T (WITH RETURN BELT LIFTING POINTS)	10.2
TM-OTX2050	2050MM LIFTING BEAM – 2T (WITH RETURN BELT LIFTING POINTS)	10.4
TM-OTX2200	2200MM LIFTING BEAM – 2T (WITH RETURN BELT LIFTING POINTS)	11.2
TM-OTX2250	2250MM LIFTING BEAM – 2T (WITH RETURN BELT LIFTING POINTS)	11.4
TM-OTX2400	2400MM LIFTING BEAM – 2T (WITH RETURN BELT LIFTING POINTS)	12.2
TM-OTX2450	2450MM LIFTING BEAM – 2T (WITH RETURN BELT LIFTING POINTS)	12.4
TM-OTX2600	2600MM LIFTING BEAM – 2T (WITH RETURN BELT LIFTING POINTS)	13.2
TM-OTX2700	2700MM LIFTING BEAM – 2T (WITH RETURN BELT LIFTING POINTS)	13.7
TM-OTXCUST	CUSTOM LIFTING BEAM – 2T (WITH RETURN BELT LIFTING POINTS)	-

LIFTING BEAM DIMENSIONS

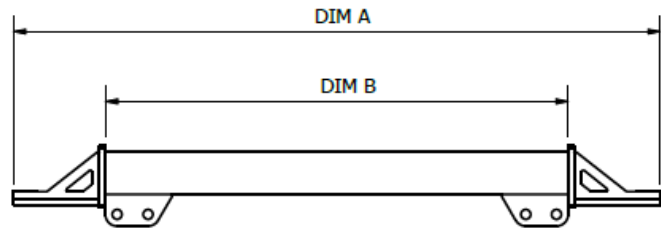

PART NUMBER	DIMENSION A	DIMENSION B
TM-OTX900	1404	940
TM-OTX1050	1554	1090
TM-OTX1200	1704	1240
TM-OTX1350	1854	1390
TM-OTX1400	1904	1440
TM-OTX1500	2004	1540
TM-OTX1550	2054	1590
TM-OTX1600	2104	1640
TM-OTX1700	2204	1740
TM-OTX1800	2304	1840
TM-OTX2000	2504	2040
TM-OTX2050	2554	2090
TM-OTX2200	2704	2240
TM-OTX2400	2904	2440
TM-OTX2450	3004	2490
TM-OTX2600	3104	2640
TM-OTX2700	3204	2740
TM-OTXCUST	CUSTOM	CUSTOM

TROUGH BEAM ON CHAINS

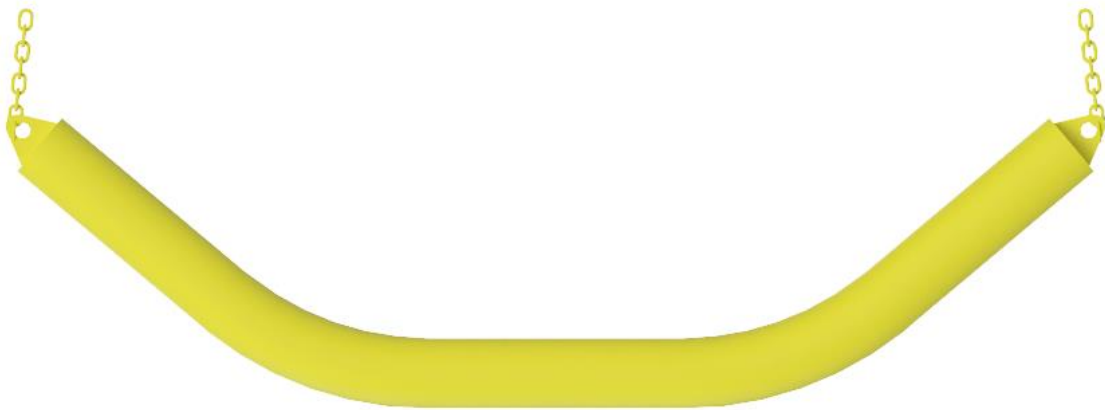

1T TROUGH LIFTING BEAM ON CHAINS

PART NUMBER	DETAILS	WEIGHT (KG)
TM-STBC750	750MM LIFTING BEAM ON CHAINS – 1T (WITH RETURN BELT LIFTING POINTS)	6.3
TM-STBC900	900MM LIFTING BEAM ON CHAINS – 1T (WITH RETURN BELT LIFTING POINTS)	6.5
TM-STBC950	950MM LIFTING BEAM ON CHAINS – 1T (WITH RETURN BELT LIFTING POINTS)	6.7
TM-STBC1000	1000MM LIFTING BEAM ON CHAINS – 1T (WITH RETURN BELT LIFTING POINTS)	6.9
TM-STBC1050	1050MM LIFTING BEAM ON CHAINS – 1T (WITH RETURN BELT LIFTING POINTS)	7.1
TM-STBC1200	1200MM LIFTING BEAM ON CHAINS – 1T (WITH RETURN BELT LIFTING POINTS)	7.7
TM-STBC1250	1250MM LIFTING BEAM ON CHAINS – 1T (WITH RETURN BELT LIFTING POINTS)	7.9
TM-STBC1350	1350MM LIFTING BEAM ON CHAINS – 1T (WITH RETURN BELT LIFTING POINTS)	8.1
TM-STBC1400	1400MM LIFTING BEAM ON CHAINS – 1T (WITH RETURN BELT LIFTING POINTS)	8.8
TM-STBC1450	1450MM LIFTING BEAM ON CHAINS – 1T (WITH RETURN BELT LIFTING POINTS)	9.2
TM-STBC1500	1500MM LIFTING BEAM ON CHAINS – 1T (WITH RETURN BELT LIFTING POINTS)	9.4
TM-STBC1550	1550MM LIFTING BEAM ON CHAINS – 1T (WITH RETURN BELT LIFTING POINTS)	9.6
TM-STBC1600	1600MM LIFTING BEAM ON CHAINS – 1T (WITH RETURN BELT LIFTING POINTS)	9.8
TM-STBC1650	1650MM LIFTING BEAM ON CHAINS – 1T (WITH RETURN BELT LIFTING POINTS)	10.0
TM-STBC1800	1800MM LIFTING BEAM ON CHAINS – 1T (WITH RETURN BELT LIFTING POINTS)	10.4
TM-STBC1850	1850MM LIFTING BEAM ON CHAINS – 1T (WITH RETURN BELT LIFTING POINTS)	10.6
TM-STBC1900	1900MM LIFTING BEAM ON CHAINS – 1T (WITH RETURN BELT LIFTING POINTS)	10.7
TM-STBC2000	2000MM LIFTING BEAM ON CHAINS – 1T (WITH RETURN BELT LIFTING POINTS)	11.0
TM-STBC2050	2050MM LIFTING BEAM ON CHAINS – 1T (WITH RETURN BELT LIFTING POINTS)	11.2
TM-STBC2200	2200MM LIFTING BEAM ON CHAINS – 1T (WITH RETURN BELT LIFTING POINTS)	11.4
TM-STBC2250	2250MM LIFTING BEAM ON CHAINS – 1T (WITH RETURN BELT LIFTING POINTS)	11.6
TM-STBC2400	2400MM LIFTING BEAM ON CHAINS – 1T (WITH RETURN BELT LIFTING POINTS)	11.8
TM-STBC2450	2450MM LIFTING BEAM ON CHAINS – 1T (WITH RETURN BELT LIFTING POINTS)	12.0
TM-STBC2500	2500MM LIFTING BEAM ON CHAINS – 1T (WITH RETURN BELT LIFTING POINTS)	12.2
TM-STBC2600	2600MM LIFTING BEAM ON CHAINS – 1T (WITH RETURN BELT LIFTING POINTS)	12.5

LIFTING BEAM DIMENSIONS

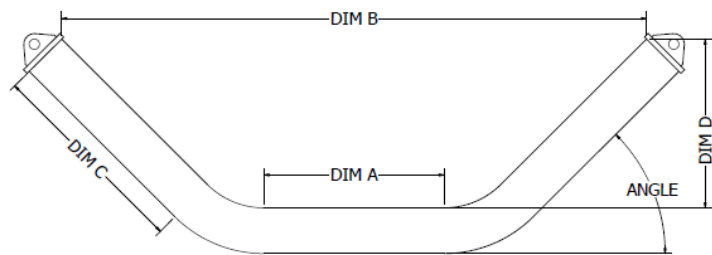

35° TROUGH ANGLE

PART NUMBER	DIM A	DIM B	DIM C	DIM D	ANGLE
TM-STBC750X35	150	820	300	200	35
TM-STBC900X35	200	952	350	229	35
TM-STBC950X35	220	996	365	237	35
TM-STBC1000X35	260	1045	370	240	35
TM-STBC1050X35	280	1089	385	249	35
TM-STBC1200X35	350	1184	400	258	35
TM-STBC1250X35	370	1269	440	281	35
TM-STBC1350X35	400	1357	475	301	35
TM-STBC1400X35	420	1401	490	309	35
TM-STBC1450X35	440	1446	505	318	35
TM-STBC1500X35	450	1489	525	329	35
TM-STBC1550X35	470	1533	540	338	35
TM-STBC1600X35	490	1578	555	346	35
TM-STBC1650X35	500	1620	575	358	35
TM-STBC1800X35	540	1751	630	389	35
TM-STBC1850X35	580	1799	635	392	35
TM-STBC1900X35	620	1847	640	395	35
TM-STBC2000X35	650	1934	675	415	35
TM-STBC2050X35	670	1979	690	424	35
TM-STBC2200X35	710	2109	745	455	35
TM-STBC2250X35	730	2154	760	464	35
TM-STBC2400X35	770	2284	815	496	35
TM-STBC2450X35	790	2328	830	504	35
TM-STBC2500X35	810	2373	845	513	35
TM-STBC2600X35	840	2460	880	533	35

NOTES

1. DIMENSIONS PROVIDED ARE APPROXIMATES.
2. PLEASE PROVIDE DRAWINGS OF CONVEYOR STRINGERS AND IDLER FRAMES FOR MORE ACCURATE BEAM SELECTION.

LIFTING BEAM DIMENSIONS

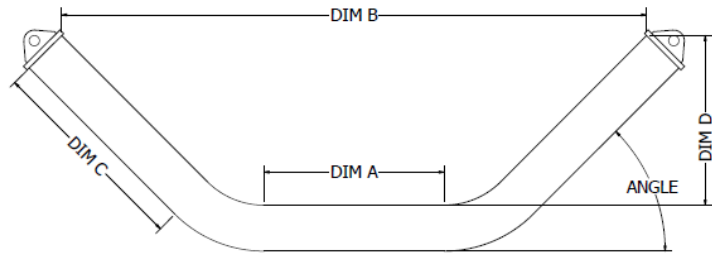

40° TROUGH ANGLE

PART NUMBER	DIM A	DIM B	DIM C	DIM D	ANGLE
TM-STBC750	150	810	300	229	40
TM- STBC900	200	936	350	261	40
TM- STBC950	220	979	365	271	40
TM-STBC1000	260	1027	370	274	40
TM-STBC1050	280	1070	385	284	40
TM-STBC1200	350	1163	400	294	40
TM-STBC1250	370	1244	440	319	40
TM-STBC1350	400	1328	475	342	40
TM-STBC1400	420	1371	490	351	40
TM-STBC1450	440	1414	505	361	40
TM-STBC1500	450	1454	525	374	40
TM-STBC1550	470	1497	540	383	40
TM-STBC1600	490	1540	555	393	40
TM-STBC1650	500	1581	575	406	40
TM-STBC1800	540	1705	630	441	40
TM-STBC1850	580	1753	635	445	40
TM-STBC1900	620	1801	640	448	40
TM-STBC2000	650	1884	675	470	40
TM-STBC2050	670	1927	690	480	40
TM-STBC2200	710	2051	745	515	40
TM-STBC2250	730	2094	760	525	40
TM-STBC2400	770	2219	815	560	40
TM-STBC2450	790	2262	830	570	40
TM-STBC2500	810	2305	845	580	40
TM-STBC2600	840	2388	880	602	40

NOTES

1. DIMENSIONS PROVIDED ARE APPROXIMATES.
2. PLEASE PROVIDE DRAWINGS OF CONVEYOR STRINGERS AND IDLER FRAMES FOR MORE ACCURATE BEAM SELECTION.

LIFTING BEAM DIMENSIONS

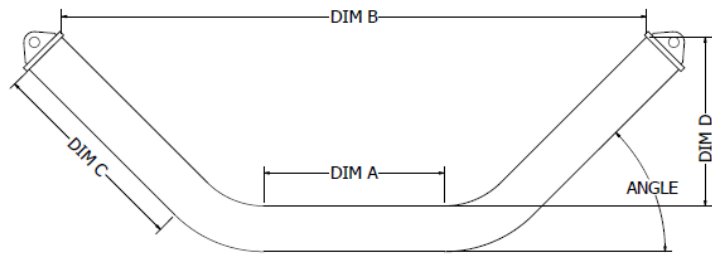

45° TROUGH ANGLE

PART NUMBER	DIM A	DIM B	DIM C	DIM D	ANGLE
TM-STBC750X45	150	794	300	258	45
TM-STBC900X45	200	915	350	293	45
TM-STBC950X45	220	956	365	304	45
TM-STBC1000X45	260	1003	370	307	45
TM-STBC1050X45	280	1044	385	318	45
TM-STBC1200X45	350	1136	400	328	45
TM-STBC1250X45	370	1212	440	357	45
TM-STBC1350X45	400	1292	475	381	45
TM-STBC1400X45	420	1333	490	392	45
TM-STBC1450X45	440	1374	505	403	45
TM-STBC1500X45	450	1412	525	417	45
TM-STBC1550X45	470	1454	540	427	45
TM-STBC1600X45	490	1495	555	438	45
TM-STBC1650X45	500	1533	575	452	45
TM-STBC1800X45	540	1651	630	491	45
TM-STBC1850X45	580	1698	635	495	45
TM-STBC1900X45	620	1745	640	498	45
TM-STBC2000X45	650	1825	675	523	45
TM-STBC2050X45	670	1866	690	533	45
TM-STBC2200X45	710	1984	745	572	45
TM-STBC2250X45	730	2025	760	583	45
TM-STBC2400X45	770	2143	815	622	45
TM-STBC2450X45	790	2184	830	632	45
TM-STBC2500X45	810	2225	845	643	45
TM-STBC2600X45	840	2304	880	668	45

NOTES

1. DIMENSIONS PROVIDED ARE APPROXIMATES.
2. PLEASE PROVIDE DRAWINGS OF CONVEYOR STRINGERS AND IDLER FRAMES FOR MORE ACCURATE BEAM SELECTION.

1.5T TROUGH LIFTING BEAM ON CHAINS

PART NUMBER	DETAILS	WEIGHT (KG)
TM-LTBC750	750MM LIFTING BEAM ON CHAINS – 1.5T (WITH RETURN BELT LIFTING POINTS)	6.3
TM-LTBC900	900MM LIFTING BEAM ON CHAINS – 1.5T (WITH RETURN BELT LIFTING POINTS)	6.5
TM-LTBC950	950MM LIFTING BEAM ON CHAINS – 1.5T (WITH RETURN BELT LIFTING POINTS)	6.7
TM-LTBC1000	1000MM LIFTING BEAM ON CHAINS – 1.5T (WITH RETURN BELT LIFTING POINTS)	6.9
TM-LTBC1050	1050MM LIFTING BEAM ON CHAINS – 1.5T (WITH RETURN BELT LIFTING POINTS)	7.1
TM-LTBC1200	1200MM LIFTING BEAM ON CHAINS – 1.5T (WITH RETURN BELT LIFTING POINTS)	7.7
TM-LTBC1250	1250MM LIFTING BEAM ON CHAINS – 1.5T (WITH RETURN BELT LIFTING POINTS)	7.9
TM-LTBC1350	1350MM LIFTING BEAM ON CHAINS – 1.5T (WITH RETURN BELT LIFTING POINTS)	8.1
TM-LTBC1400	1400MM LIFTING BEAM ON CHAINS – 1.5T (WITH RETURN BELT LIFTING POINTS)	8.8
TM-LTBC1450	1450MM LIFTING BEAM ON CHAINS – 1.5T (WITH RETURN BELT LIFTING POINTS)	9.2
TM-LTBC1500	1500MM LIFTING BEAM ON CHAINS – 1.5T (WITH RETURN BELT LIFTING POINTS)	9.4
TM-LTBC1550	1550MM LIFTING BEAM ON CHAINS – 1.5T (WITH RETURN BELT LIFTING POINTS)	9.6
TM-LTBC1600	1600MM LIFTING BEAM ON CHAINS – 1.5T (WITH RETURN BELT LIFTING POINTS)	12.7
TM-LTBC1650	1650MM LIFTING BEAM ON CHAINS – 1.5T (WITH RETURN BELT LIFTING POINTS)	13.2
TM-LTBC1800	1800MM LIFTING BEAM ON CHAINS – 1.5T (WITH RETURN BELT LIFTING POINTS)	15.3
TM-LTBC1850	1850MM LIFTING BEAM ON CHAINS – 1.5T (WITH RETURN BELT LIFTING POINTS)	15.7
TM-LTBC2000	2000MM LIFTING BEAM ON CHAINS – 1.5T (WITH RETURN BELT LIFTING POINTS)	16.6
TM-LTBC2050	2050MM LIFTING BEAM ON CHAINS – 1.5T (WITH RETURN BELT LIFTING POINTS)	17.1
TM-LTBC2200	2200MM LIFTING BEAM ON CHAINS – 1.5T (WITH RETURN BELT LIFTING POINTS)	18.0
TM-LTBC2250	2250MM LIFTING BEAM ON CHAINS – 1.5T (WITH RETURN BELT LIFTING POINTS)	18.3
TM-LTBC2400	2400MM LIFTING BEAM ON CHAINS – 1.5T (WITH RETURN BELT LIFTING POINTS)	19.0
TM-LTBC2450	2450MM LIFTING BEAM ON CHAINS – 1.5T (WITH RETURN BELT LIFTING POINTS)	19.2
TM-LTBC2500	2500MM LIFTING BEAM ON CHAINS – 1.5T (WITH RETURN BELT LIFTING POINTS)	19.4
TM-LTBC2600	2600MM LIFTING BEAM ON CHAINS – 1.5T (WITH RETURN BELT LIFTING POINTS)	19.8

LIFTING BEAM DIMENSIONS

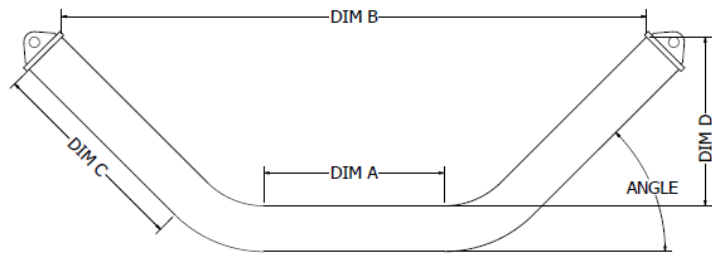

35° TROUGH ANGLE

PART NUMBER	DIM A	DIM B	DIM C	DIM D	ANGLE
TM-LTBC750X35	150	820	300	200	35
TM-LTBC900X35	200	952	350	229	35
TM-LTBC950X35	220	996	365	237	35
TM-LTBC1000X35	260	1045	370	240	35
TM-LTBC1050X35	280	1089	385	249	35
TM-LTBC1200X35	350	1184	400	258	35
TM-LTBC1250X35	370	1269	440	281	35
TM-LTBC1350X35	400	1357	475	301	35
TM-LTBC1400X35	420	1401	490	309	35
TM-LTBC1450X35	440	1446	505	318	35
TM-LTBC1500X35	450	1489	525	329	35
TM-LTBC1550X35	470	1533	540	338	35
TM-LTBC1600X35	320	1754	640	428	35
TM-LTBC1650X35	340	1799	655	437	35
TM-LTBC1800X35	390	1931	705	465	35
TM-LTBC1850X35	410	1975	720	474	35
TM-LTBC2000X35	470	2109	765	500	35
TM-LTBC2050X35	490	2154	780	508	35
TM-LTBC2200X35	550	2287	825	534	35
TM-LTBC2250X35	570	2332	840	543	35
TM-LTBC2400X35	630	2466	885	568	35
TM-LTBC2450X35	650	2510	900	577	35
TM-LTBC2500X35	670	2555	915	586	35
TM-LTBC2600X35	710	2644	945	603	35

NOTES

1. DIMENSIONS PROVIDED ARE APPROXIMATES.
2. PLEASE PROVIDE DRAWINGS OF CONVEYOR STRINGERS AND IDLER FRAMES FOR MORE ACCURATE BEAM SELECTION.

LIFTING BEAM DIMENSIONS

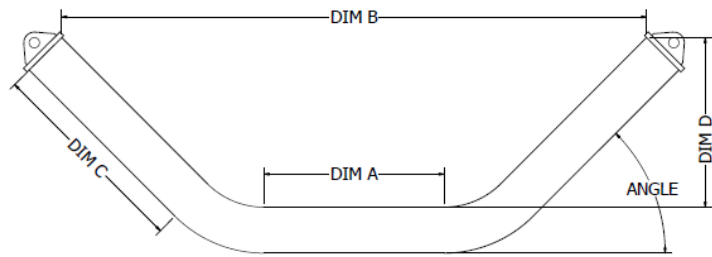

40° TROUGH ANGLE

PART NUMBER	DIM A	DIM B	DIM C	DIM D	ANGLE
TM-LTBC750	150	810	300	229	40
TM-LTBC900	200	936	350	261	40
TM-LTBC950	220	979	365	271	40
TM-LTBC1000	260	1027	370	274	40
TM-LTBC1050	280	1070	385	284	40
TM-LTBC1200	350	1163	400	294	40
TM-LTBC1250	370	1244	440	319	40
TM-LTBC1350	400	1328	475	342	40
TM-LTBC1400	420	1371	490	351	40
TM-LTBC1450	440	1414	505	361	40
TM-LTBC1500	450	1454	525	374	40
TM-LTBC1550	470	1497	540	383	40
TM-LTBC1600	320	1733	640	490	40
TM-LTBC1650	340	1776	655	500	40
TM-LTBC1800	390	1903	705	532	40
TM-LTBC1850	410	1946	720	541	40
TM-LTBC2000	470	2074	765	570	40
TM-LTBC2050	490	2117	780	580	40
TM-LTBC2200	550	2246	825	609	40
TM-LTBC2250	570	2289	840	619	40
TM-LTBC2400	630	2418	885	648	40
TM-LTBC2450	650	2461	900	657	40
TM-LTBC2500	670	2504	915	667	40
TM-LTBC2600	710	2590	945	686	40

NOTES

1. DIMENSIONS PROVIDED ARE APPROXIMATES.
2. PLEASE PROVIDE DRAWINGS OF CONVEYOR STRINGERS AND IDLER FRAMES FOR MORE ACCURATE BEAM SELECTION.

LIFTING BEAM DIMENSIONS

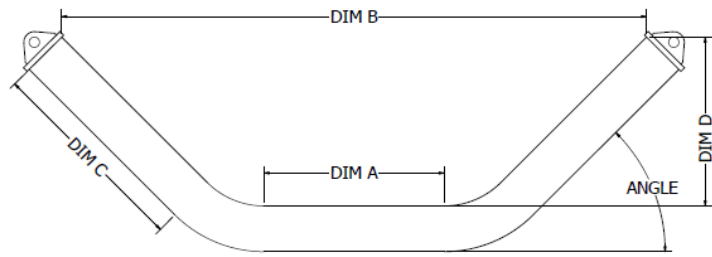

45° TROUGH ANGLE

PART NUMBER	DIM A	DIM B	DIM C	DIM D	ANGLE
TM-LTBC750X45	150	794	300	258	45
TM-LTBC900X45	200	915	350	293	45
TM-LTBC950X45	220	956	365	304	45
TM-LTBC1000X45	260	1003	370	307	45
TM-LTBC1050X45	280	1044	385	318	45
TM-LTBC1200X45	350	1136	400	328	45
TM-LTBC1250X45	370	1212	440	357	45
TM-LTBC1350X45	400	1292	475	381	45
TM-LTBC1400X45	420	1333	490	392	45
TM-LTBC1450X45	440	1374	505	403	45
TM-LTBC1500X45	450	1412	525	417	45
TM-LTBC1550X45	470	1454	540	427	45
TM-LTBC1600X45	320	1701	640	551	45
TM-LTBC1650X45	340	1742	655	562	45
TM-LTBC1800X45	390	1863	705	597	45
TM-LTBC1850X45	410	1904	720	608	45
TM-LTBC2000X45	470	2028	765	639	45
TM-LTBC2050X45	490	2069	780	650	45
TM-LTBC2200X45	550	2192	825	682	45
TM-LTBC2250X45	570	2234	840	692	45
TM-LTBC2400X45	630	2357	885	724	45
TM-LTBC2450X45	650	2398	900	735	45
TM-LTBC2500X45	670	2440	915	746	45
TM-LTBC2600X45	710	2522	945	767	45

NOTES

1. DIMENSIONS PROVIDED ARE APPROXIMATES.
2. PLEASE PROVIDE DRAWINGS OF CONVEYOR STRINGERS AND IDLER FRAMES FOR MORE ACCURATE BEAM SELECTION.

2T TROUGH LIFTING BEAM ON CHAINS

PART NUMBER	DETAILS	WEIGHT (KG)
TM-XTBC750	750MM LIFTING BEAM ON CHAINS – 2T (WITH RETURN BELT LIFTING POINTS)	6.3
TM-XTBC900	900MM LIFTING BEAM ON CHAINS – 2T (WITH RETURN BELT LIFTING POINTS)	6.5
TM-XTBC950	950MM LIFTING BEAM ON CHAINS – 2T (WITH RETURN BELT LIFTING POINTS)	6.7
TM-XTBC1000	1000MM LIFTING BEAM ON CHAINS – 2T (WITH RETURN BELT LIFTING POINTS)	6.9
TM-XTBC1050	1050MM LIFTING BEAM ON CHAINS – 2T (WITH RETURN BELT LIFTING POINTS)	7.1
TM-XTBC1200	1200MM LIFTING BEAM ON CHAINS – 2T (WITH RETURN BELT LIFTING POINTS)	7.7
TM-XTBC1250	1250MM LIFTING BEAM ON CHAINS – 2T (WITH RETURN BELT LIFTING POINTS)	7.9
TM-XTBC1350	1350MM LIFTING BEAM ON CHAINS – 2T (WITH RETURN BELT LIFTING POINTS)	8.1
TM-XTBC1400	1400MM LIFTING BEAM ON CHAINS – 2T (WITH RETURN BELT LIFTING POINTS)	8.8
TM-XTBC1450	1450MM LIFTING BEAM ON CHAINS – 2T (WITH RETURN BELT LIFTING POINTS)	9.2
TM-XTBC1500	1500MM LIFTING BEAM ON CHAINS – 2T (WITH RETURN BELT LIFTING POINTS)	9.4
TM-XTBC1550	1550MM LIFTING BEAM ON CHAINS – 2T (WITH RETURN BELT LIFTING POINTS)	9.6
TM-XTBC1600	1600MM LIFTING BEAM ON CHAINS – 2T (WITH RETURN BELT LIFTING POINTS)	12.7
TM-XTBC1650	1650MM LIFTING BEAM ON CHAINS – 2T (WITH RETURN BELT LIFTING POINTS)	13.2
TM-XTBC1800	1800MM LIFTING BEAM ON CHAINS – 2T (WITH RETURN BELT LIFTING POINTS)	15.3
TM-XTBC1850	1850MM LIFTING BEAM ON CHAINS – 2T (WITH RETURN BELT LIFTING POINTS)	15.7
TM-XTBC2000	2000MM LIFTING BEAM ON CHAINS – 2T (WITH RETURN BELT LIFTING POINTS)	16.6
TM-XTBC2050	2050MM LIFTING BEAM ON CHAINS – 2T (WITH RETURN BELT LIFTING POINTS)	17.1
TM-XTBC2200	2200MM LIFTING BEAM ON CHAINS – 2T (WITH RETURN BELT LIFTING POINTS)	18.0
TM-XTBC2250	2250MM LIFTING BEAM ON CHAINS – 2T (WITH RETURN BELT LIFTING POINTS)	18.3
TM-XTBC2400	2400MM LIFTING BEAM ON CHAINS – 2T (WITH RETURN BELT LIFTING POINTS)	19.0
TM-XTBC2450	2450MM LIFTING BEAM ON CHAINS – 2T (WITH RETURN BELT LIFTING POINTS)	19.2
TM-XTBC2500	2500MM LIFTING BEAM ON CHAINS – 2T (WITH RETURN BELT LIFTING POINTS)	19.4
TM-XTBC2600	2600MM LIFTING BEAM ON CHAINS – 2T (WITH RETURN BELT LIFTING POINTS)	19.8
TM-XTBC2700	2700MM LIFTING BEAM ON CHAINS – 2T (WITH RETURN BELT LIFTING POINTS)	20.2
TM-XTBC3000	3000MM LIFTING BEAM ON CHAINS – 2T (WITH RETURN BELT LIFTING POINTS)	21.4

LIFTING BEAM DIMENSIONS

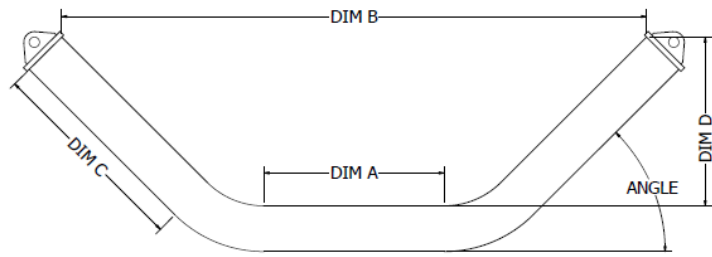

35° TROUGH ANGLE

PART NUMBER	DIM A	DIM B	DIM C	DIM D	ANGLE
TM-XTBC750X35	150	820	300	200	35
TM- XTBC900X35	200	952	350	229	35
TM- XTBC950X35	220	996	365	237	35
TM-XTBC1000X35	260	1045	370	240	35
TM-XTBC1050X35	280	1089	385	249	35
TM-XTBC1200X35	350	1184	400	258	35
TM-XTBC1250X35	370	1269	440	281	35
TM-XTBC1350X35	400	1357	475	301	35
TM-XTBC1400X35	420	1401	490	309	35
TM-XTBC1450X35	440	1446	505	318	35
TM-XTBC1500X35	450	1489	525	329	35
TM-XTBC1550X35	470	1533	540	338	35
TM-XTBC1600X35	320	1754	640	428	35
TM-XTBC1650X35	340	1799	655	437	35
TM-XTBC1800X35	390	1931	705	465	35
TM-XTBC1850X35	410	1975	720	474	35
TM-XTBC2000X35	470	2109	765	500	35
TM-XTBC2050X35	490	2154	780	508	35
TM-XTBC2200X35	550	2287	825	534	35
TM-XTBC2250X35	570	2332	840	543	35
TM-XTBC2400X35	630	2466	885	568	35
TM-XTBC2450X35	650	2510	900	577	35
TM-XTBC2500X35	670	2555	915	586	35
TM-XTBC2600X35	710	2644	945	603	35

NOTES

1. DIMENSIONS PROVIDED ARE APPROXIMATES.
2. PLEASE PROVIDE DRAWINGS OF CONVEYOR STRINGERS AND IDLER FRAMES FOR MORE ACCURATE BEAM SELECTION.

LIFTING BEAM DIMENSIONS

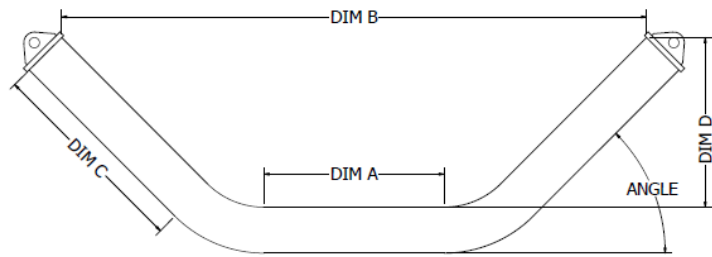

40° TROUGH ANGLE

PART NUMBER	DIM A	DIM B	DIM C	DIM D	ANGLE
TM-XTBC750	150	810	300	229	40
TM- XTBC900	200	936	350	261	40
TM- XTBC950	220	979	365	271	40
TM-XTBC1000	260	1027	370	274	40
TM-XTBC1050	280	1070	385	284	40
TM-XTBC1200	350	1163	400	294	40
TM-XTBC1250	370	1244	440	319	40
TM-XTBC1350	400	1328	475	342	40
TM-XTBC1400	420	1371	490	351	40
TM-XTBC1450	440	1414	505	361	40
TM-XTBC1500	450	1454	525	374	40
TM-XTBC1550	470	1497	540	383	40
TM-XTBC1600	320	1733	640	490	40
TM-XTBC1650	340	1776	655	500	40
TM-XTBC1800	390	1903	705	532	40
TM-XTBC1850	410	1946	720	541	40
TM-XTBC2000	470	2074	765	570	40
TM-XTBC2050	490	2117	780	580	40
TM-XTBC2200	550	2246	825	609	40
TM-XTBC2250	570	2289	840	619	40
TM-XTBC2400	630	2418	885	648	40
TM-XTBC2450	650	2461	900	657	40
TM-XTBC2500	670	2504	915	667	40
TM-XTBC2600	710	2590	945	686	40

NOTES

1. DIMENSIONS PROVIDED ARE APPROXIMATES.
2. PLEASE PROVIDE DRAWINGS OF CONVEYOR STRINGERS AND IDLER FRAMES FOR MORE ACCURATE BEAM SELECTION.

LIFTING BEAM DIMENSIONS

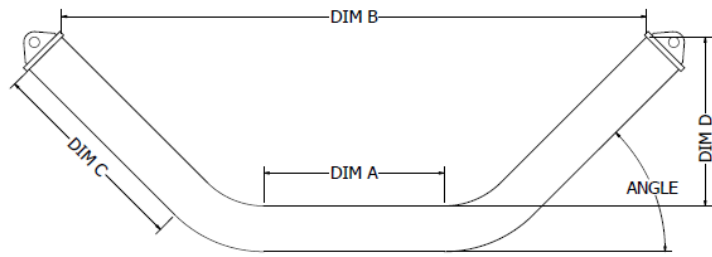

45° TROUGH ANGLE

PART NUMBER	DIM A	DIM B	DIM C	DIM D	ANGLE
TM-XTBC750X45	150	794	300	258	45
TM- XTBC900X45	200	915	350	293	45
TM- XTBC950X45	220	956	365	304	45
TM-XTBC1000X45	260	1003	370	307	45
TM-XTBC1050X45	280	1044	385	318	45
TM-XTBC1200X45	350	1136	400	328	45
TM-XTBC1250X45	370	1212	440	357	45
TM-XTBC1350X45	400	1292	475	381	45
TM-XTBC1400X45	420	1333	490	392	45
TM-XTBC1450X45	440	1374	505	403	45
TM-XTBC1500X45	450	1412	525	417	45
TM-XTBC1550X45	470	1454	540	427	45
TM-XTBC1600X45	320	1701	640	551	45
TM-XTBC1650X45	340	1742	655	562	45
TM-XTBC1800X45	390	1863	705	597	45
TM-XTBC1850X45	410	1904	720	608	45
TM-XTBC2000X45	470	2028	765	639	45
TM-XTBC2050X45	490	2069	780	650	45
TM-XTBC2200X45	550	2192	825	682	45
TM-XTBC2250X45	570	2234	840	692	45
TM-XTBC2400X45	630	2357	885	724	45
TM-XTBC2450X45	650	2398	900	735	45
TM-XTBC2500X45	670	2440	915	746	45
TM-XTBC2600X45	710	2522	945	767	45

NOTES

1. DIMENSIONS PROVIDED ARE APPROXIMATES.
2. PLEASE PROVIDE DRAWINGS OF CONVEYOR STRINGERS AND IDLER FRAMES FOR MORE ACCURATE BEAM SELECTION.

CUSTOM SOLUTIONS

PLEASE PROVIDE CONVEYOR CROSS SECTIONAL DRAWINGS OR ALTERNATIVELY INPUT THE CONVEYOR DIMENSIONS IN THE TABLE BELOW.

BELT INFORMATION	
REFERENCE	DIMENSIONS (MM)
A	
B	
C	
D	
E	
F	
G	
H	
I	
BELT WIDTH	
COVER INSTALLED - Y/N	
PLEASE PROVIDE BELT DESIGN DATA SHEET IF AVAILABLE	

PRODUCT SELECTION		
ITEM	YES	NO
I		
HYDRAULIC BELT LIFTER – SLING LIFTER		
HYDRAULIC BELT LIFTER – SPECIAL PROFILED BEAM		
MECHANICAL BELT LIFTER		
RETURN BELT LIFTING BEAM		
ROLLER REMOVAL TOOL		
TECHMINE HYDRAULIC POWER PACK		

CONTACT INFORMATION	
FIELD	DETAILS
NAME	
COMPANY/SITE	
EMAIL/PHONE	

TECHMINE SOLUTIONS
Techmine Solutions Pty. Ltd
 35 Chatterline Way
 Lathropdale
 Western Australia, 6105
 Email - info@techmine.com.au

DATE	5/02/2021
ISSUE	1
APPROVED	
CHECKED	
DATE	5/02/2021
SCALE	1:12

THIS DRAWING AND THE DESIGN AND CONSTRUCTION OF THE CONVEYOR SYSTEM IS THE PROPERTY OF TECHMINE SOLUTIONS PTY. LTD. IT IS TO BE USED ONLY FOR THE PROJECT AND SITE SPECIFICALLY IDENTIFIED IN THE DRAWING. ANY REUSE, REPRODUCTION, OR MODIFICATION OF THIS DRAWING WITHOUT THE WRITTEN PERMISSION OF TECHMINE SOLUTIONS PTY. LTD. IS STRICTLY PROHIBITED. THE USER OF THIS DRAWING SHALL BE RESPONSIBLE FOR OBTAINING ALL NECESSARY PERMITS AND APPROVALS FROM THE APPROPRIATE AUTHORITIES. THE USER SHALL BE RESPONSIBLE FOR OBTAINING ALL NECESSARY PERMITS AND APPROVALS FROM THE APPROPRIATE AUTHORITIES. THE USER SHALL BE RESPONSIBLE FOR OBTAINING ALL NECESSARY PERMITS AND APPROVALS FROM THE APPROPRIATE AUTHORITIES.

TROUGH BEAMS ON CHAINS CAN BE CUSTOM MADE FOR EACH APPLICATION. PLEASE REFER TO CONVEYOR BELT QUESTIONNAIRE FOR MORE DETAILS. QUESTIONNAIRE IS AVAILABLE AT WWW.TECHMINE.COM.AU.

MODELS

PART NUMBER	DESCRIPTION
TM-STBCCUSTOM	1.0T TROUGH LIFTING BEAM ON CHAIN
TM-LTBCCUSTOM	1.5T TROUGH LIFTING BEAM ON CHAIN
TM-XTBCCUSTOM	2.0T TROUGH LIFTING BEAM ON CHAIN

V-BENT LIFTING BEAMS

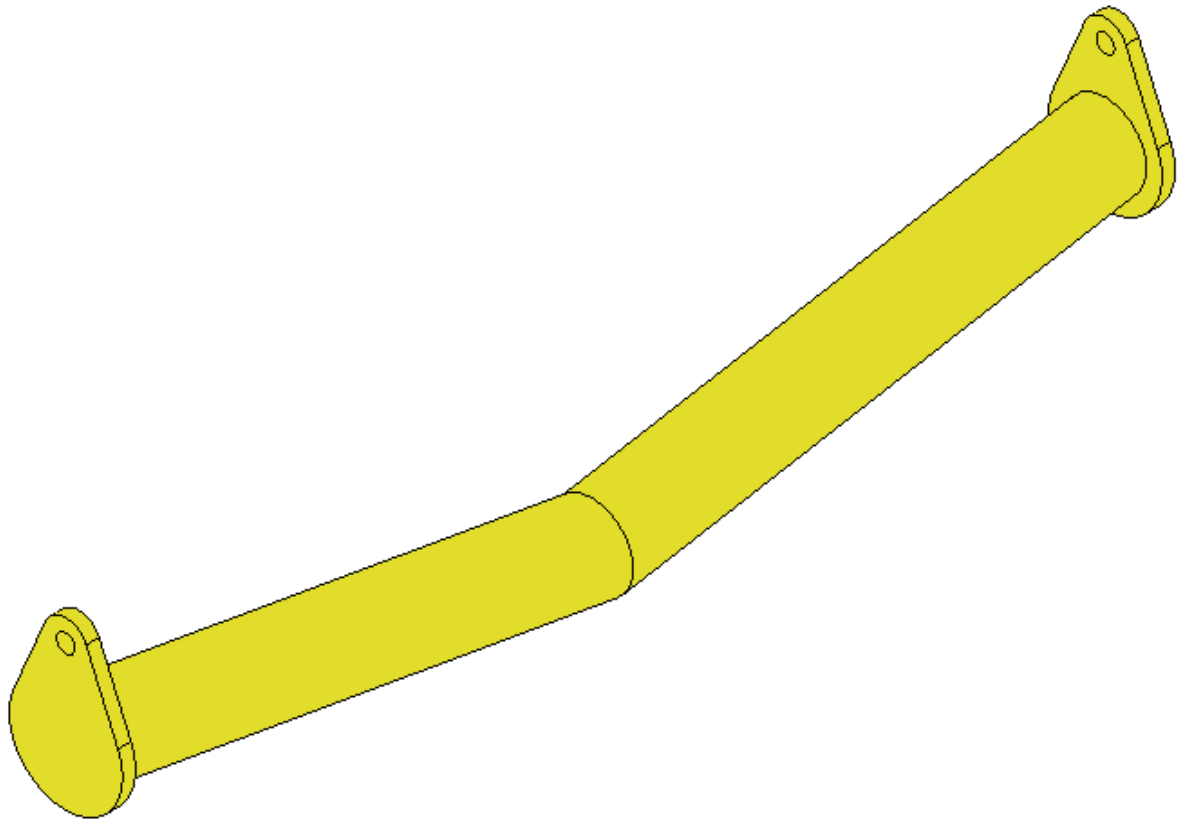

1T V-BENT LIFTING BEAMS

PART NUMBER	DETAILS	WEIGHT (KG)
TM-SVB760	760MM LIFTING BEAM – 1T	2.7
TM-SVB900	900MM LIFTING BEAM – 1T	3.1
TM-SVB950	950MM LIFTING BEAM – 1T	3.4
TM-SVB1000	1000MM LIFTING BEAM – 1T	3.7
TM-SVB1050	1050MM LIFTING BEAM – 1T	3.9
TM-SVB1200	1200MM LIFTING BEAM – 1T	5.7
TM-SVB1250	1250MM LIFTING BEAM – 1T	5.9
TM-SVB1350	1350MM LIFTING BEAM – 1T	6.6
TM-SVB1400	1400MM LIFTING BEAM – 1T	7.2
TM-SVB1450	1450MM LIFTING BEAM – 1T	7.5
TM-SVB1500	1500MM LIFTING BEAM – 1T	7.8
TM-SVB1550	1550MM LIFTING BEAM – 1T	8.2
TM-SVB1600	1600MM LIFTING BEAM – 1T	8.5
TM-SVB1650	1650MM LIFTING BEAM – 1T	8.9
TM-SVB1800	1800MM LIFTING BEAM – 1T	9.5
TM-SVB1850	1850MM LIFTING BEAM – 1T	9.8
TM-SVB2000	2000MM LIFTING BEAM – 1T	10.5
TM-SVB2050	2050MM LIFTING BEAM – 1T	10.8
TM-SVB2200	2200MM LIFTING BEAM – 1T	11.5
TM-SVB2250	2250MM LIFTING BEAM – 1T	11.8
TM-SVB2400	2400MM LIFTING BEAM – 1T	12.5
TM-SVB2450	2450MM LIFTING BEAM – 1T	12.8
TM-SVB2500	2500MM LIFTING BEAM – 1T	13.1
TM-SVB2600	2600MM LIFTING BEAM – 1T	13.6
TM-SVB2700	2700MM LIFTING BEAM – 1T	14.0
TM-SVB3000	3000MM LIFTING BEAM – 1T	16.5

LIFTING BEAM DIMENSIONS

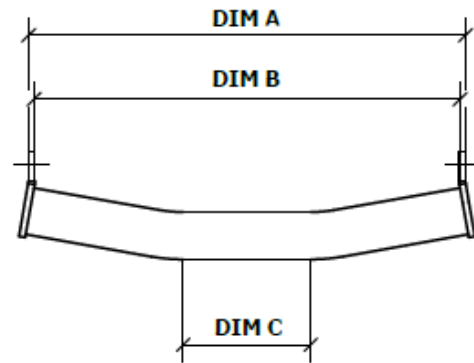

SMALL

PART NUMBER	DIMENSION A	DIMENSION B	DIMENSION C
TM-SVB760	824	800	240
TM-SVB900	964	940	287
TM-SVB950	1014	990	304
TM-SVB1000	1064	1040	321
TM-SVB1050	1114	1090	338
TM-SVB1200	1264	1240	389
TM-SVB1250	1314	1290	406
TM-SVB1350	1414	1390	440
TM-SVB1400	1464	1440	457
TM-SVB1450	1514	1490	474
TM-SVB1500	1564	1540	491
TM-SVB1550	1614	1590	508

LIFTING BEAM DIMENSIONS

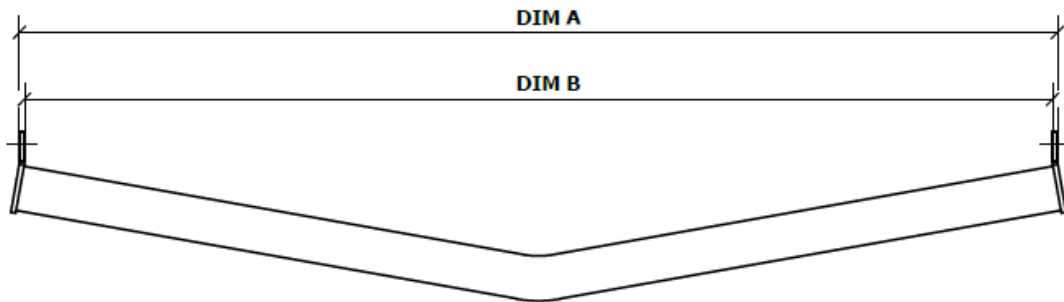

LARGE

PART NUMBER	DIMENSION A	DIMENSION B
TM-SVB1600	1664	1640
TM-SVB1650	1714	1690
TM-SVB1800	1864	1840
TM-SVB1850	1914	1890
TM-SVB2000	2064	2040
TM-SVB2050	2114	2090
TM-SVB2200	2264	2240
TM-SVB2250	2314	2290
TM-SVB2400	2464	2440
TM-SVB2450	2514	2490
TM-SVB2500	2564	2540
TM-SVB2600	2664	2640
TM-SVB2700	2764	2740
TM-SVB3000	3064	3040

1.5T V-BENT LIFTING BEAMS

PART NUMBER	DETAILS	WEIGHT (KG)
TM-LVB760	760MM V-BENT LIFTING BEAM – 1.5T	2.7
TM-LVB900	900MM V-BENT LIFTING BEAM – 1.5T	3.1
TM-LVB950	950MM V-BENT LIFTING BEAM – 1.5T	3.4
TM-LVB1000	1000MM V-BENT LIFTING BEAM – 1.5T	3.7
TM-LVB1050	1050MM V-BENT LIFTING BEAM – 1.5T	3.9
TM-LVB1200	1200MM V-BENT LIFTING BEAM – 1.5T	5.7
TM-LVB1250	1250MM V-BENT LIFTING BEAM – 1.5T	5.9
TM-LVB1350	1350MM V-BENT LIFTING BEAM – 1.5T	6.6
TM-LVB1400	1400MM V-BENT LIFTING BEAM – 1.5T	7.2
TM-LVB1450	1450MM V-BENT LIFTING BEAM – 1.5T	7.5
TM-LVB1500	1500MM V-BENT LIFTING BEAM – 1.5T	7.8
TM-LVB1550	1550MM V-BENT LIFTING BEAM – 1.5T	8.2
TM-LVB1600	1600MM V-BENT LIFTING BEAM – 1.5T	8.5
TM-LVB1650	1650MM V-BENT LIFTING BEAM – 1.5T	8.9
TM-LVB1800	1800MM V-BENT LIFTING BEAM – 1.5T	9.5
TM-LVB1850	1850MM V-BENT LIFTING BEAM – 1.5T	9.8
TM-LVB1950	1950MM V-BENT LIFTING BEAM – 1.5T	10.2
TM-LVB2000	2000MM V-BENT LIFTING BEAM – 1.5T	10.5
TM-LVB2050	2050MM V-BENT LIFTING BEAM – 1.5T	10.8
TM-LVB2200	2200MM V-BENT LIFTING BEAM – 1.5T	11.5
TM-LVB2250	2250MM V-BENT LIFTING BEAM – 1.5T	11.8
TM-LVB2400	2400MM V-BENT LIFTING BEAM – 1.5T	12.5
TM-LVB2450	2450MM V-BENT LIFTING BEAM – 1.5T	12.8
TM-LVB2500	2500MM V-BENT LIFTING BEAM – 1.5T	13.1
TM-LVB2600	2600MM V-BENT LIFTING BEAM – 1.5T	13.6
TM-LVB2700	2700MM V-BENT LIFTING BEAM – 1.5T	14.0
TM-LVB3000	3000MM V-BENT LIFTING BEAM – 1.5T	16.5

LIFTING BEAM DIMENSIONS

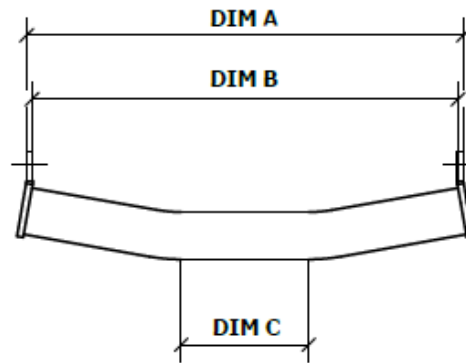

SMALL

PART NUMBER	DIMENSION A	DIMENSION B	DIMENSION C
TM-LVB760	824	800	240
TM-LVB900	964	940	287
TM-LVB950	1014	990	304
TM-LVB1000	1064	1040	321
TM-LVB1050	1114	1090	338
TM-LVB1200	1264	1240	389
TM-LVB1250	1314	1290	406
TM-LVB1350	1414	1390	440
TM-LVB1400	1464	1440	457
TM-LVB1450	1514	1490	474
TM-LVB1500	1564	1540	491
TM-LVB1550	1614	1590	508

LIFTING BEAM DIMENSIONS

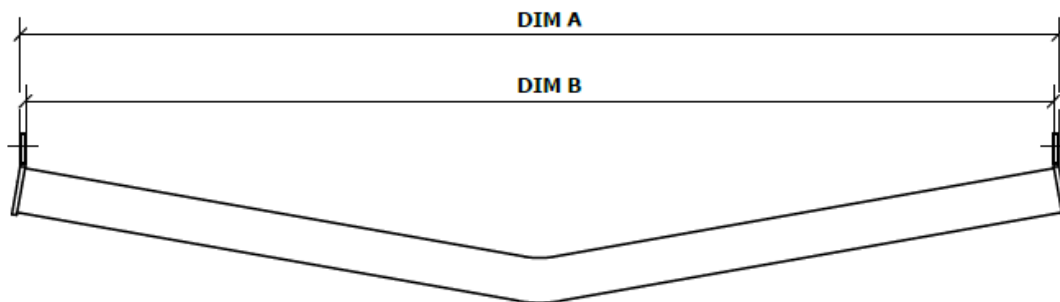

LARGE

PART NUMBER	DIMENSION A	DIMENSION B
TM-LVB1600	1664	1640
TM-LVB1650	1714	1690
TM-LVB1800	1864	1840
TM-LVB1850	1914	1890
TM-LVB1950	2014	1990
TM-LVB2000	2064	2040
TM-LVB2050	2114	2090
TM-LVB2200	2264	2240
TM-LVB2250	2314	2290
TM-LVB2400	2464	2440
TM-LVB2450	2514	2490
TM-LVB2500	2564	2540
TM-LVB2600	2664	2640
TM-LVB2700	2764	2740
TM-LVB3000	3064	3040

2T V-BENT LIFTING BEAMS

PART NUMBER	DETAILS	WEIGHT (KG)
TM-XVB760	760MM LIFTING BEAM – 2T	2.7
TM-XVB900	900MM LIFTING BEAM – 2T	3.1
TM-XVB950	950MM LIFTING BEAM – 2T	3.4
TM-XVB1000	1000MM LIFTING BEAM – 2T	3.7
TM-XVB1050	1050MM LIFTING BEAM – 2T	3.9
TM-XVB1200	1200MM LIFTING BEAM – 2T	5.7
TM-XVB1250	1250MM LIFTING BEAM – 2T	5.9
TM-XVB1350	1350MM LIFTING BEAM – 2T	6.6
TM-XVB1400	1400MM LIFTING BEAM – 2T	7.2
TM-XVB1450	1450MM LIFTING BEAM – 2T	7.5
TM-XVB1500	1500MM LIFTING BEAM – 2T	7.8
TM-XVB1550	1550MM LIFTING BEAM – 2T	8.2
TM-XVB1600	1600MM LIFTING BEAM – 2T	8.5
TM-XVB1650	1650MM LIFTING BEAM – 2T	8.9
TM-XVB1700	1700MM V-BENT LIFTING BEAM – 2T	9.1
TM-XVB1800	1800MM LIFTING BEAM – 2T	9.5
TM-XVB1850	1850MM LIFTING BEAM – 2T	9.8
TM-XVB2000	2000MM LIFTING BEAM – 2T	10.5
TM-XVB2050	2050MM LIFTING BEAM – 2T	10.8
TM-XVB2100	2100MM V-BENT LIFTING BEAM – 2T	11.1
TM-XVB2150	2150MM V-BENT LIFTING BEAM – 2T	11.3
TM-XVB2200	2200MM LIFTING BEAM – 2T	11.5
TM-XVB2250	2250MM LIFTING BEAM – 2T	11.8
TM-XVB2400	2400MM LIFTING BEAM – 2T	12.5
TM-XVB2450	2450MM LIFTING BEAM – 2T	12.8
TM-XVB2500	2500MM LIFTING BEAM – 2T	13.1
TM-XVB2600	2600MM LIFTING BEAM – 2T	13.6
TM-XVB2700	2700MM LIFTING BEAM – 2T	14.0
TM-XVB3000	3000MM LIFTING BEAM – 2T	16.5

LIFTING BEAM DIMENSIONS

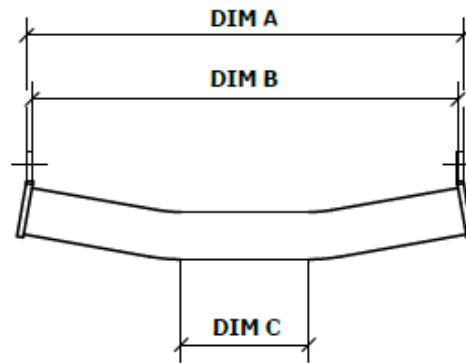

SMALL

PART NUMBER	DIMENSION A	DIMENSION B	DIMENSION C
TM-XVB760	824	800	240
TM-XVB900	964	940	287
TM-XVB950	1014	990	304
TM-XVB1000	1064	1040	321
TM-XVB1050	1114	1090	338
TM-XVB1200	1264	1240	389
TM-XVB1250	1314	1290	406
TM-XVB1350	1414	1390	440
TM-XVB1400	1464	1440	457
TM-XVB1450	1514	1490	474
TM-XVB1500	1564	1540	491
TM-XVB1550	1614	1590	508

LIFTING BEAM DIMENSIONS

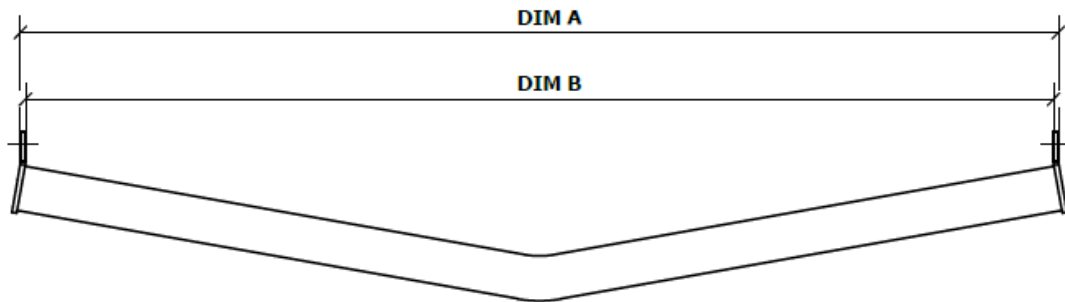

LARGE

PART NUMBER	DIMENSION A	DIMENSION B
TM-XVB1600	1664	1640
TM-XVB1650	1714	1690
TM-XVB1700	1764	1740
TM-XVB1800	1864	1840
TM-XVB1850	1914	1890
TM-XVB2000	2064	2040
TM-XVB2050	2114	2090
TM-XVB2100	2164	2140
TM-XVB2150	2214	2190
TM-XVB2200	2264	2240
TM-XVB2250	2314	2290
TM-XVB2400	2464	2440
TM-XVB2450	2514	2490
TM-XVB2500	2564	2540
TM-XVB2600	2664	2640
TM-XVB2700	2764	2740
TM-XVB3000	3064	3040

FLAT LIFTING BEAMS

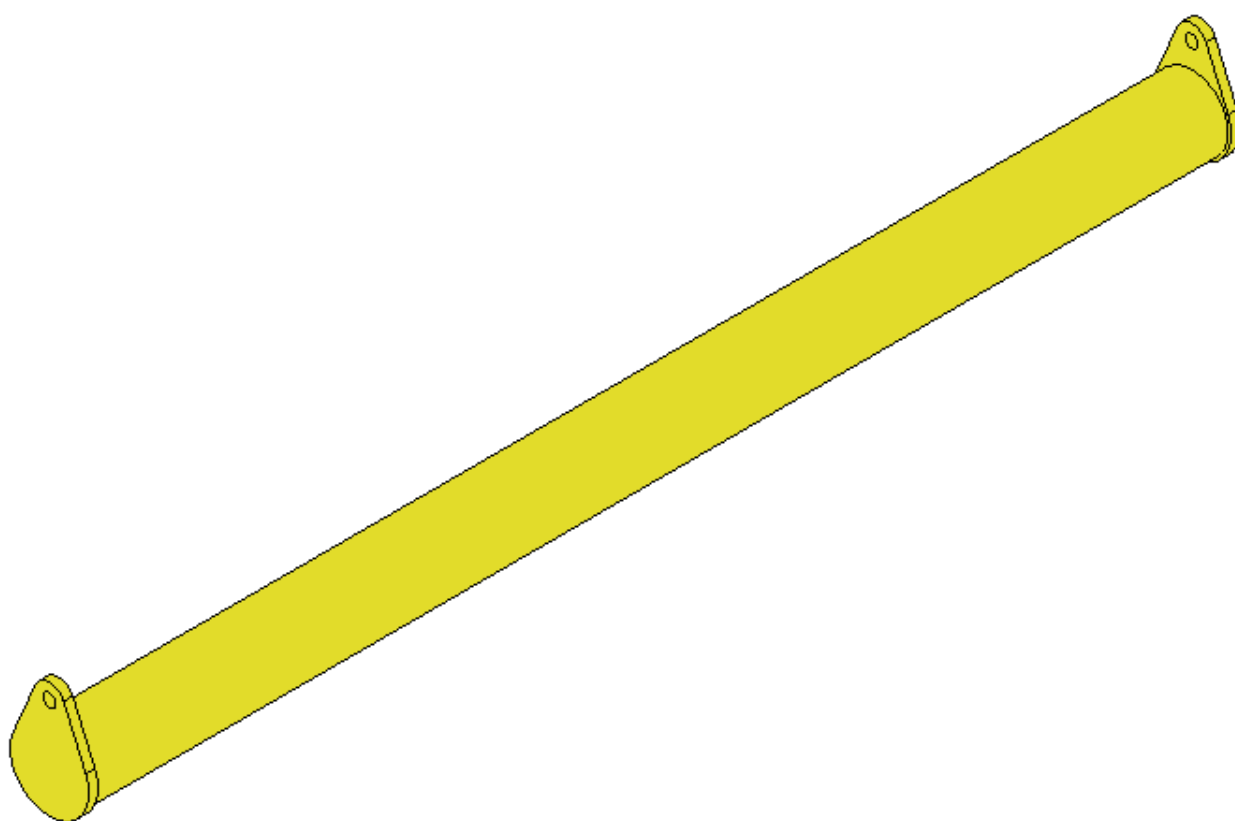

1T FLAT LIFTING BEAMS

PART NUMBER	DETAILS	WEIGHT (KG)
TM-SFB760	760MM LIFTING BEAM – 1T	2.7
TM-SFB900	900MM LIFTING BEAM – 1T	3.1
TM-SFB950	950MM LIFTING BEAM – 1T	3.4
TM-SFB1000	1000MM LIFTING BEAM – 1T	3.7
TM-SFB1050	1050MM LIFTING BEAM – 1T	3.9
TM-SFB1200	1200MM LIFTING BEAM – 1T	5.7
TM-SFB1250	1250MM LIFTING BEAM – 1T	5.9
TM-SFB1350	1350MM LIFTING BEAM – 1T	6.6
TM-SFB1400	1400MM LIFTING BEAM – 1T	7.2
TM-SFB1450	1450MM LIFTING BEAM – 1T	7.5
TM-SFB1500	1500MM LIFTING BEAM – 1T	7.8
TM-SFB1550	1550MM LIFTING BEAM – 1T	8.2
TM-SFB1600	1600MM LIFTING BEAM – 1T	8.5
TM-SFB1650	1650MM LIFTING BEAM – 1T	8.9
TM-SFB1800	1800MM LIFTING BEAM – 1T	9.5
TM-SFB1850	1850MM LIFTING BEAM – 1T	9.8
TM-SFB2000	2000MM LIFTING BEAM – 1T	10.5
TM-SFB2050	2050MM LIFTING BEAM – 1T	10.8
TM-SFB2200	2200MM LIFTING BEAM – 1T	11.5
TM-SFB2250	2250MM LIFTING BEAM – 1T	11.8
TM-SFB2400	2400MM LIFTING BEAM – 1T	12.5
TM-SFB2450	2450MM LIFTING BEAM – 1T	12.8
TM-SFB2500	2500MM LIFTING BEAM – 1T	13.1
TM-SFB2600	2600MM LIFTING BEAM – 1T	13.6
TM-SFB2700	2700MM LIFTING BEAM – 1T	14.0
TM-SFB3000	3000MM LIFTING BEAM – 1T	16.5

LIFTING BEAM DIMENSIONS

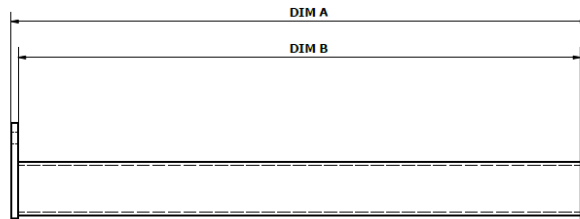

PART NUMBER	DIMENSION A	DIMENSION B
TM-SFB760	824	800
TM-SFB900	964	940
TM-SFB950	1014	990
TM-SFB1000	1064	1040
TM-SFB1050	1114	1090
TM-SFB1200	1264	1240
TM-SFB1250	1314	1290
TM-SFB1350	1414	1390
TM-SFB1400	1464	1440
TM-SFB1450	1514	1490
TM-SFB1500	1564	1540
TM-SFB1550	1614	1590
TM-SFB1600	1664	1640
TM-SFB1650	1714	1690
TM-SFB1800	1864	1840
TM-SFB1850	1914	1890
TM-SFB2000	2064	2040
TM-SFB2050	2114	2090
TM-SFB2200	2264	2240
TM-SFB2250	2314	2290
TM-SFB2400	2464	2440
TM-SFB2450	2514	2490
TM-SFB2500	2564	2540
TM-SFB2600	2664	2640
TM-SFB2700	2764	2740
TM-SFB3000	3064	3040

1.5T FLAT LIFTING BEAMS

PART NUMBER	DETAILS	WEIGHT (KG)
TM-LFB760	760MM LIFTING BEAM – 1.5T	2.7
TM-LFB900	900MM LIFTING BEAM – 1.5T	3.1
TM-LFB950	950MM LIFTING BEAM – 1.5T	3.4
TM-LFB1000	1000MM LIFTING BEAM – 1.5T	3.7
TM-LFB1050	1050MM LIFTING BEAM – 1.5T	3.9
TM-LFB1200	1200MM LIFTING BEAM – 1.5T	5.7
TM-LFB1250	1250MM LIFTING BEAM – 1.5T	5.9
TM-LFB1300	1300MM LIFTING BEAM – 1.5T	6.2
TM-LFB1350	1350MM LIFTING BEAM – 1.5T	6.6
TM-LFB1400	1400MM LIFTING BEAM – 1.5T	7.2
TM-LFB1450	1450MM LIFTING BEAM – 1.5T	7.5
TM-LFB1500	1500MM LIFTING BEAM – 1.5T	7.8
TM-LFB1550	1550MM LIFTING BEAM – 1.5T	8.2
TM-LFB1600	1600MM LIFTING BEAM – 1.5T	8.5
TM-LFB1650	1650MM LIFTING BEAM – 1.5T	8.9
TM-LFB1800	1800MM LIFTING BEAM – 1.5T	9.5
TM-LFB1850	1850MM LIFTING BEAM – 1.5T	9.8
TM-LFB1950	1950MM LIFTING BEAM – 1.5T	10.3
TM-LFB2000	2000MM LIFTING BEAM – 1.5T	10.5
TM-LFB2050	2050MM LIFTING BEAM – 1.5T	10.8
TM-LFB2200	2200MM LIFTING BEAM – 1.5T	11.5
TM-LFB2250	2250MM LIFTING BEAM – 1.5T	11.8
TM-LFB2400	2400MM LIFTING BEAM – 1.5T	12.5
TM-LFB2450	2450MM LIFTING BEAM – 1.5T	12.8
TM-LFB2500	2500MM LIFTING BEAM – 1.5T	13.1
TM-LFB2600	2600MM LIFTING BEAM – 1.5T	13.6
TM-LFB2700	2700MM LIFTING BEAM – 1.5T	14.0
TM-LFB3000	3000MM LIFTING BEAM – 1.5T	16.5

LIFTING BEAM DIMENSIONS

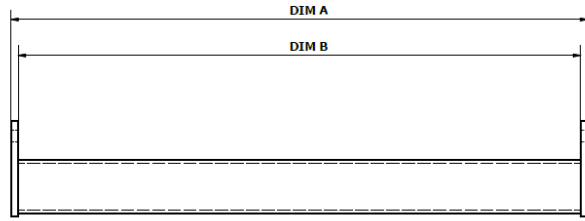

PART NUMBER	DIMENSION A	DIMENSION B
TM-LFB760	824	800
TM-LFB900	964	940
TM-LFB950	1014	990
TM-LFB1000	1064	1040
TM-LFB1050	1114	1090
TM-LFB1200	1264	1240
TM-LFB1250	1314	1290
TM-LFB1300	1364	1340
TM-LFB1350	1414	1390
TM-LFB1400	1464	1440
TM-LFB1450	1514	1490
TM-LFB1500	1564	1540
TM-LFB1550	1614	1590
TM-LFB1600	1664	1640
TM-LFB1650	1714	1690
TM-LFB1800	1864	1840
TM-LFB1850	1914	1890
TM-LFB1950	2014	1990
TM-LFB2000	2064	2040
TM-LFB2050	2114	2090
TM-LFB2200	2264	2240
TM-LFB2250	2314	2290
TM-LFB2400	2464	2440
TM-LFB2450	2514	2490
TM-LFB2500	2564	2540
TM-LFB2600	2664	2640
TM-LFB2700	2764	2740
TM-LFB3000	3064	3040

2T FLAT LIFTING BEAMS

PART NUMBER	DETAILS	WEIGHT (KG)
TM-XFB900	900MM LIFTING BEAM – 2T	3.1
TM-XFB950	950MM LIFTING BEAM – 2T	3.4
TM-XFB1000	1000MM LIFTING BEAM – 2T	3.7
TM-XFB1050	1050MM LIFTING BEAM – 2T	3.9
TM-XFB1200	1200MM LIFTING BEAM – 2T	5.7
TM-XFB1250	1250MM LIFTING BEAM – 2T	5.9
TM-XFB1300	1300MM LIFTING BEAM – 2T	6.3
TM-XFB1350	1350MM LIFTING BEAM – 2T	6.6
TM-XFB1400	1400MM LIFTING BEAM – 2T	7.2
TM-XFB1450	1450MM LIFTING BEAM – 2T	7.5
TM-XFB1500	1500MM LIFTING BEAM – 2T	7.8
TM-XFB1550	1550MM LIFTING BEAM – 2T	8.2
TM-XFB1600	1600MM LIFTING BEAM – 2T	8.5
TM-XFB1650	1650MM LIFTING BEAM – 2T	8.9
TM-XFB1700	1700MM LIFTING BEAM – 2T	9.1
TM-XFB1800	1800MM LIFTING BEAM – 2T	9.5
TM-XFB1850	1850MM LIFTING BEAM – 2T	9.8
TM-XFB1900	1900MM LIFTING BEAM – 2T	10.1
TM-XFB2000	2000MM LIFTING BEAM – 2T	10.5
TM-XFB2050	2050MM LIFTING BEAM – 2T	10.8
TM-XFB2100	2100MM LIFTING BEAM – 2T	11.1
TM-XFB2150	2150MM LIFTING BEAM – 2T	11.3
TM-XFB2200	2200MM LIFTING BEAM – 2T	11.5
TM-XFB2250	2250MM LIFTING BEAM – 2T	11.8
TM-XFB2400	2400MM LIFTING BEAM – 2T	12.5
TM-XFB2450	2450MM LIFTING BEAM – 2T	12.8
TM-XFB2500	2500MM LIFTING BEAM – 2T	13.1
TM-XFB2600	2600MM LIFTING BEAM – 2T	13.6
TM-XFB2700	2700MM LIFTING BEAM – 2T	14.0
TM-XFB3000	3000MM LIFTING BEAM – 2T	16.5

LIFTING BEAM DIMENSIONS

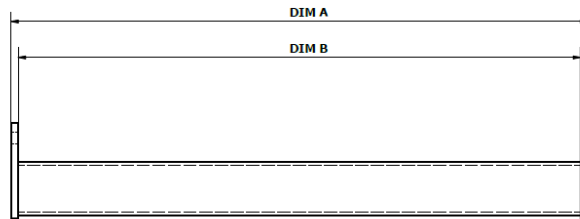

PART NUMBER	DIMENSION A	DIMENSION B
TM-XFB900	964	940
TM-XFB950	1014	990
TM-XFB1000	1064	1040
TM-XFB1050	1114	1090
TM-XFB1200	1264	1240
TM-XFB1250	1314	1290
TM-XFB1300	1364	1340
TM-XFB1350	1414	1390
TM-XFB1400	1464	1440
TM-XFB1450	1514	1490
TM-XFB1500	1564	1540
TM-XFB1550	1614	1590
TM-XFB-1600	1664	1640
TM-XFB-1650	1714	1690
TM-XFB-1700	1764	1740
TM-XFB-1800	1864	1840
TM-XFB-1850	1914	1890
TM-XFB-1900	1964	1940
TM-XFB-2000	2064	2040
TM-XFB-2050	2114	2090
TM-XFB-2200	2264	2240
TM-XFB-2250	2314	2290
TM-XFB-2400	2464	2440
TM-XFB-2450	2514	2490
TM-XFB-2500	2564	2540
TM-XFB-2600	2664	2640
TM-XFB-2700	2764	2740
TM-XFB-3000	3064	3040

3T FLAT LIFTING BEAMS

PART NUMBER	DETAILS	WEIGHT (KG)
TM-XXFB1800	1800MM LIFTING BEAM – 3T	15.5
TM-XXFB1850	1850MM LIFTING BEAM – 3T	16.0
TM-XXFB1950	1950MM LIFTING BEAM – 3T	17.0
TM-XXFB2000	2000MM LIFTING BEAM – 3T	17.5
TM-XXFB2050	2050MM LIFTING BEAM – 3T	18.0
TM-XXFB2100	2100MM LIFTING BEAM – 3T	18.5
TM-XXFB2200	2200MM LIFTING BEAM – 3T	19.5
TM-XXFB2250	2250MM LIFTING BEAM – 3T	20.0
TM-XXFB2300	2300MM LIFTING BEAM – 3T	20.5
TM-XXFB2400	2400MM LIFTING BEAM – 3T	21.5
TM-XXFB2450	2450MM LIFTING BEAM – 3T	22.0
TM-XXFB2500	2500MM LIFTING BEAM – 3T	22.5
TM-XXFB2600	2600MM LIFTING BEAM – 3T	23.5
TM-XXFB2700	2700MM LIFTING BEAM – 3T	24.5

LIFTING BEAM DIMENSIONS

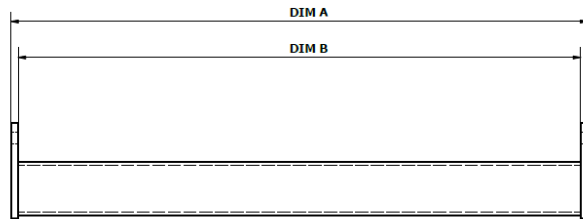

PART NUMBER	DIMENSION A	DIMENSION B
TM-XXFB1800	1880	1848
TM-XXFB1850	1930	1898
TM-XXFB1950	2030	1998
TM-XXFB2000	2080	2048
TM-XXFB2050	2130	2098
TM-XXFB2100	2180	2148
TM-XXFB2200	2280	2248
TM-XXFB2250	2330	2298
TM-XXFB2300	2380	2348
TM-XXFB2400	2480	2448
TM-XXFB2450	2530	2498
TM-XXFB2500	2580	2548
TM-XXFB2600	2680	2648
TM-XXFB2700	2780	2748

3.5T FLAT LIFTING BEAMS

PART NUMBER	DETAILS	WEIGHT (KG)
TM-XXXFB1800	1800MM LIFTING BEAM – 3.5T	17.0
TM-XXXFB1850	1850MM LIFTING BEAM – 3.5T	17.5
TM-XXXFB1950	1950MM LIFTING BEAM – 3.5T	18.5
TM-XXXFB2000	2000MM LIFTING BEAM – 3.5T	19.0
TM-XXXFB2050	2050MM LIFTING BEAM – 3.5T	19.5
TM-XXXFB2100	2100MM LIFTING BEAM – 3.5T	20.0
TM-XXXFB2200	2200MM LIFTING BEAM – 3.5T	21.0
TM-XXXFB2250	2250MM LIFTING BEAM – 3.5T	21.5
TM-XXXFB2300	2300MM LIFTING BEAM – 3.5T	22.0
TM-XXXFB2400	2400MM LIFTING BEAM – 3.5T	23.0
TM-XXXFB2450	2450MM LIFTING BEAM – 3.5T	23.5
TM-XXXFB2500	2500MM LIFTING BEAM – 3.5T	24.0
TM-XXXFB2600	2600MM LIFTING BEAM – 3.5T	25.0
TM-XXXFB2700	2700MM LIFTING BEAM – 3.5T	26.0

LIFTING BEAM DIMENSIONS

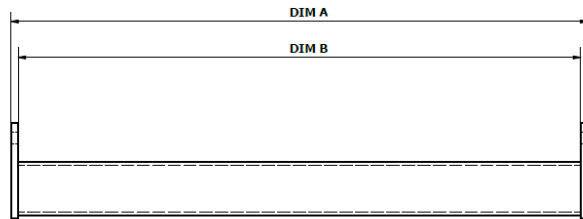

PART NUMBER	DIMENSION A	DIMENSION B
TM-XXXFB1800	1880	1848
TM-XXXFB1850	1930	1898
TM-XXXFB1950	2030	1998
TM-XXXFB2000	2080	2048
TM-XXXFB2050	2130	2098
TM-XXXFB2100	2180	2148
TM-XXXFB2200	2280	2248
TM-XXXFB2250	2330	2298
TM-XXXFB2300	2380	2348
TM-XXXFB2400	2480	2448
TM-XXXFB2450	2530	2498
TM-XXXFB2500	2580	2548
TM-XXXFB2600	2680	2648
TM-XXXFB2700	2780	2748

HYDRAULIC BELT LIFTER

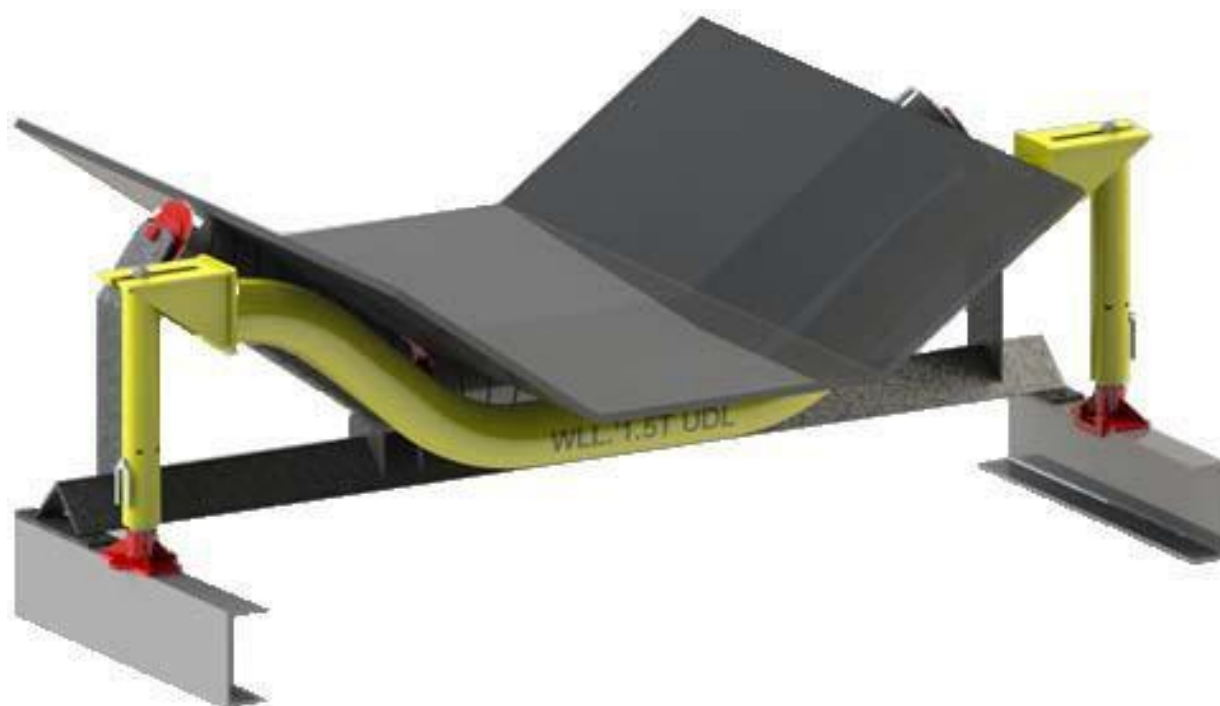

LIFTING COMPONENTS

PART NUMBER	DETAILS	WEIGHT (KG)
TMBL-CYLL	2X HYDRAULIC LIFTING TELESCOPE ASSEMBLY (350MM MAXIMUM LIFT)	7.5 (EACH) 15.0 (TOTAL)
TMBL-CYLS	2X HYDRAULIC LIFTING TELESCOPE ASSEMBLY (250MM MAXIMUM LIFT)	6.2 (EACH) 12.4 (TOTAL)
TM-BL-CYLL-XLF	TWO HYDRAULIC LIFTING TELESCOPE ASSEMBLIES (WITH 350MM LIFT HEIGHT, LARGE FEET)	8.0 (EACH) 16.0 (TOTAL)
TM-OUT-LRG	LARGE OUTER TELESCOPE	-
TM-OUT-SML	SMALL OUTER TELESCOPE	-

MISCELLANEOUS NOTES

DETAILS	
1.	QUICK RELEASE HYDRAULIC CONNECTION POINTS
2.	LOAD TEST CERTIFICATE PROVIDED
3.	AVAILABLE IN 1T, 1.5T AND 2T LIFTING CAPACITIES
4.	PROTECTIVE CARRY/STORAGE CASE FOR HYDRAULIC TELESCOPE INCLUDED

TELESCOPE ANCILLARIES

PART NUMBER	DETAILS
TM-CYL-EXT100	100MM TELESCOPE EXTENSION
TM-CYL-EXT150	150MM TELESCOPE EXTENSION
TM-CYLF-LRG	LARGE CYLINDER FOOT
TM-CYLF-SML	SMALL CYLINDER FOOT
TM-BL-CAS3	PROTECTIVE TELESCOPE CARRY CASE
TM-SK	SEAL KIT FOR THE SML & LRG CYLINDERS (3 OFF SEALS)
TM-SNM24	M24 S/S SECURING NUT
TM-TLP	TELESCOPE LOCKING PIN WITH SECURING STRAP
TM-TSLP	TELESCOPE SAFETY LOCKING PIN
TM-SUPH4.5	SUPPLY HOSE TO CYLINDERS 4M WITH CONNECTORS EACH
TM-SUPH6	SUPPLY HOSE TO CYLINDERS 6M WITH CONNECTORS EACH

RETURN BELT LIFTING CHAINS

PART NUMBER	DETAILS
TM-CHAI600	RETURN BELT LIFTING CHAINS 600MM LONG WITH SHORTENER
TM-CHAI1000	RETURN BELT LIFTING CHAINS 1000MM LONG WITH SHORTENER
TM-CHAI1200	RETURN BELT LIFTING CHAINS 1200MM LONG WITH SHORTENER
TM-CHAI1400	RETURN BELT LIFTING CHAINS 1400MM LONG WITH SHORTENER
TM-CHAI1600	RETURN BELT LIFTING CHAINS 1600MM LONG WITH SHORTENER
TM-CHAI1700	RETURN BELT LIFTING CHAINS 1700MM LONG WITH SHORTENER
TM-CHAI1800	RETURN BELT LIFTING CHAINS 1800MM LONG WITH SHORTENER
TM-CHAI2500	RETURN BELT LIFTING CHAINS 2500MM LONG WITH SHORTENER

HYDRAULIC POWER PACK



MODELS

PART NUMBER	DETAILS	WEIGHT (KG)
HPU-1.0T	HYDRAULIC POWER UNIT – 1.0T	18.0
HPU-1.5T	HYDRAULIC POWER UNIT – 1.5T	18.2
HPU-2.0T	HYDRAULIC POWER UNIT – 2.0T	19.0

COMPONENTS

PART NUMBER	DETAILS	WEIGHT (KG)
HPU-BATT	24V DC LI-ION BATTERY	0.8
HPU-CHAR	BATTERY CHARGER	N/A
	2X FLEXIBLE HOSE (4M)	N/A
	POWER COATED CRADLE	N/A

HYDRAULIC PUMP ANCILLARIES

PART NUMBER	DETAILS
TM-PG-1.5T	1.5T TECHMINE PRESSURE GAUGE
TM-PG-2.0T	2.0T TECHMINE PRESSURE GAUGE
TM-CHAR	110/240V TECHMINE PUMP BATTERY CHARGER

TECHMINE AND ENERPAC CONVERTER



COMPONENTS

PART NUMBER	DETAILS	WEIGHT (KG)
ENER-XC	HYDRAULIC POWER UNIT	10.5
TMEN28	28V DC LI-ION BATTERY	0.8
TMECH28	BATTERY CHARGER	N/A
TM-CONV-LP	TECHMINE CONVERSION PACK WITH HOSES (SAFETY MODULE FOR 110BAR)	4.5

TECHMINE CONVERSION PACKS

PART NUMBER	DETAILS	WEIGHT (KG)
TM-CONV-LP	TECHMINE CONVERSION PACK WITH HOSES (SAFETY MODULE FOR 110BAR)	4.5
TM-CONV-MP	TECHMINE CONVERSION PACK WITH HOSES (SAFETY MODULE FOR 160BAR)	4.5
TM-CONV-HP	TECHMINE CONVERSION PACK WITH HOSES (SAFETY MODULE FOR 210BAR)	4.5

ENERPAC EQUIPMENT

PART NUMBER	DETAILS
TM-ENER-P	2 STAGE HYDRAULIC HAND PUMP
TM-ENER-XC	ENERPAC XC- PORTABLE PUMP (DE-RATED TO 210BAR,160BAR & 110BAR)
TM-CH28110V	ENERPAC BATTERY CHARGER 110V
TM-CH28240V	ENERPAC BATTERY CHARGER 240V
TM-EN28	ENERPAC SPARE BATTERY 28 VOLT

MECHANICAL BELT LIFTER

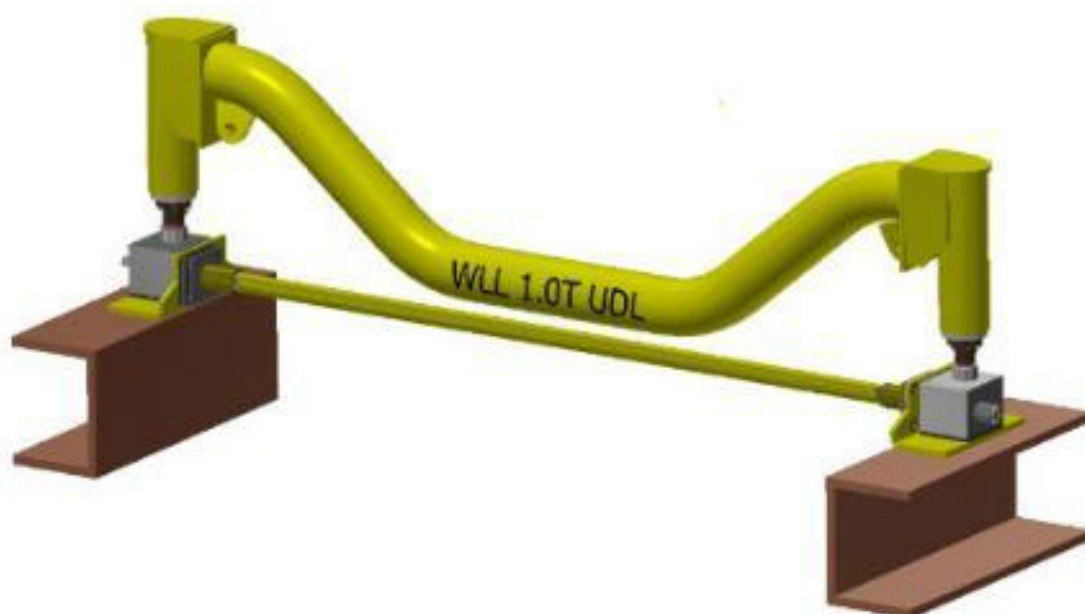

MODELS

PART NUMBER	DETAILS	WEIGHT (KG)
TM-SM900	MECHANICAL BELT LIFTER – 1.0T (FOR 900MM BELT)	19.0
TM-SM1000	MECHANICAL BELT LIFTER – 1.0T (FOR 1000MM BELT)	21.5
TM-SM1100	MECHANICAL BELT LIFTER – 1.0T (FOR 1100MM BELT)	23.8
TM-SM1200	MECHANICAL BELT LIFTER – 1.0T (FOR 1200MM BELT)	24.3
TM-SM1300	MECHANICAL BELT LIFTER – 1.0T (FOR 1300MM BELT)	24.8
TM-SM1400	MECHANICAL BELT LIFTER – 1.0T (FOR 1400MM BELT)	25.5
TM-SM1500	MECHANICAL BELT LIFTER – 1.0T (FOR 1500MM BELT)	26.3
TM-SM1600	MECHANICAL BELT LIFTER – 1.0T (FOR 1600MM BELT)	27.1
TM-SM1800	MECHANICAL BELT LIFTER – 1.0T (FOR 1800MM BELT)	28.7
TM-SM2000	MECHANICAL BELT LIFTER – 1.0T (FOR 2000MM BELT)	30.3
TM-SM2200	MECHANICAL BELT LIFTER – 1.0T (FOR 2200MM BELT)	31.9
TM-SM2400	MECHANICAL BELT LIFTER – 1.0T (FOR 2400MM BELT)	33.5
TM-SMCAST	MECHANICAL BELT LIFTER – 1.0T (FOR CUSTOM BELT)	CUSTOM

GENERAL ASSEMBLY DIMENSIONS

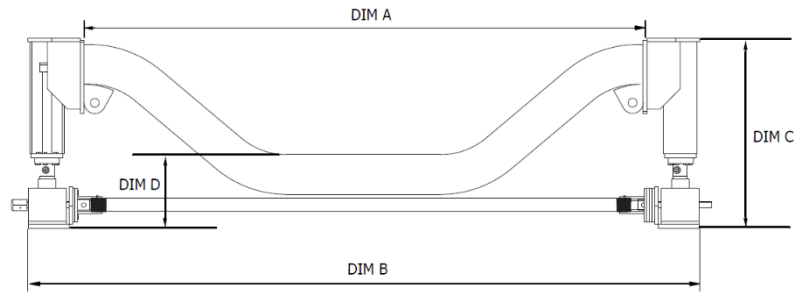

MODELS

PART NUMBER	DIM A	DIM B	DIM C (MIN)	DIM C (MAX)	DIM D (MIN)	DIM D (MAX)
TM-SM900	934	1184	410	710	219	519
TM-SM1000	-	-	-	-	-	-
TM-SM1100	-	-	-	-	-	-
TM-SM1200	1284	1534	430	730	200	500
TM-SM1300	-	-	-	-	-	-
TM-SM1400	-	-	-	-	-	-
TM-SM1500	1634	1884	514	814	194	494
TM-SM1600	1734	1984	530	830	180	480
TM-SM1800	2034	2284	640	940	260	560
TM-SM2000	2234	2484	640	940	218	518
TM-SM2200	-	-	-	-	-	-
TM-SM2400	-	-	-	-	-	-
TM-SML-CUST	CUSTOM	CUSTOM	CUSTOM	CUSTOM	CUSTOM	CUSTOM

NOTES

- DIM C (MIN) AND DIM D (MIN) REFERS TO HEIGHT WHEN HYDRAULIC TELESCOPE IS AT MINIMUM EXTENSION.
- DIM C (MAX) AND DIM D (MAX) REFERS TO HEIGHT WHEN HYDRAULIC TELESCOPE IS AT MAXIMUM EXTENSION.

MECHANICAL LIFTER SLIDE CHANNEL

PART NUMBER	DETAILS
TM-MSF1200	1200MM MECHANICAL LIFTER SLIDE CHANNEL - 1T
TM-MSF1400	1400MM MECHANICAL LIFTER SLIDE CHANNEL - 1T
TM-MSF1500	1500MM MECHANICAL LIFTER SLIDE CHANNEL - 1T
TM-MSF1800	1800MM MECHANICAL LIFTER SLIDE CHANNEL - 1T
TM-MSF2000	2000MM MECHANICAL LIFTER SLIDE CHANNEL - 1T
TM-MSF2200	2200MM MECHANICAL LIFTER SLIDE CHANNEL - 1T

MECHANICAL LIFTER ANCILLARIES

PART NUMBER	DETAILS
TM-MLS20	PAIR OF MECHANICAL LIFTER HEIGHT ADJUSTMENT SLIPPERS (20MM)
TM-MLS50	PAIR OF MECHANICAL LIFTER HEIGHT ADJUSTMENT SLIPPERS (50MM)

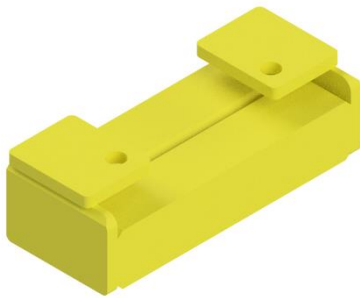

TM-MLS50

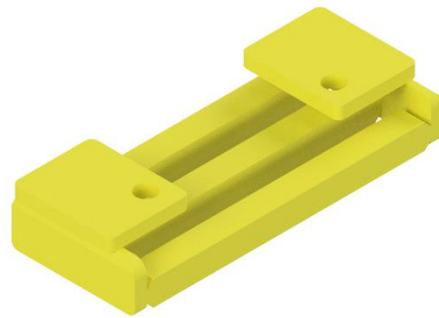

TM-MLS20

IDLER TRANSFER TOOL



DESCRIPTION

TECHMINE SOLUTION'S LIGHTWEIGHT IDLER TRANSFER TOOL REMOVES THE NEED FOR HANDS TO BE PLACED UNDER IDLERS DURING TRANSPORT, EFFECTIVELY ELIMINATING PROCESS PINCH POINTS. ITS INNOVATIVE DESIGN ENSURES THE IDLERS ARE SECURED IN THE ROTATING HASP, ALLOWING SAFE AND EFFICIENT TRANSPORT TO THE TASK SITE.

MODELS

IDLER TRANSFER TOOL QUESTIONNAIRE

PLEASE PROVIDE IDLER CROSS-SECTIONAL DIMENSIONS OR ALTERNATIVELY COMPLETE THE DIMENSIONAL REQUEST TABLE BELOW

IDLER INFORMATION	
IDLER	DIMENSIONS (MM)
A	
B	
C	
D	
E	
F	

CONTACT INFORMATION	
NAME	DESIGNATION
PHONE	
COMPANY	
CONTACT	

SCALE: 1:1

IDLER TRANSFER TOOLS ARE CUSTOM MADE FOR EACH APPLICATION. PLEASE REFER TO IDLER TRANSFER TOOL QUESTIONNAIRE FOR MORE DETAILS. QUESTIONNAIRE IS AVAILABLE AT WWW.TECHMINE.COM.AU.

PART NUMBER
TM-ITT-CUSTOM

LIGHTWEIGHT ACCESS PLANK



DESCRIPTION

TECHMINE SOLUTION'S LIGHTWEIGHT ACCESS PLANK IS FABRICATED OUT OF STRUCTURAL-GRADE ALUMINIUM, DELIVERING UNPARALLELED STRENGTH AND DURABILITY. THIS ACCESS PLANK IS EQUIPPED WITH SLIDE RAILS EFFECTIVELY ELIMINATING CATCHPOINTS AND ALLOWING THE ACCESS PLANK TO RUN SMOOTHLY ON CONVEYOR STRINGERS. RETAINING NUTS ALLOWS THE ACCESS PLANK TO BE SECURELY LOCKED ONTO THE KICKPLATE. THIS PLANK IS RATED TO A WORKING LOAD LIMIT OF 150KGS.

GENERAL ASSEMBLY DIMENSIONS

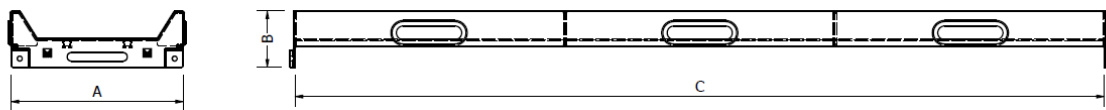

PART NUMBER	DIM A	DIM B	DIM C	WEIGHT (KG)
TM-LAP-1200	500	163	1750	13.0
TM-LAP-1500	500	163	2050	16.0
TM-LAP-1800	500	163	2350	19.0
TM-LAP-2000	500	163	2550	21.0
TM-LAP-2400	500	163	2950	26.0
TM-LAP-CUST	500	163	CUSTOM	CUSTOM

ADJUSTABLE LIFTING BEAM

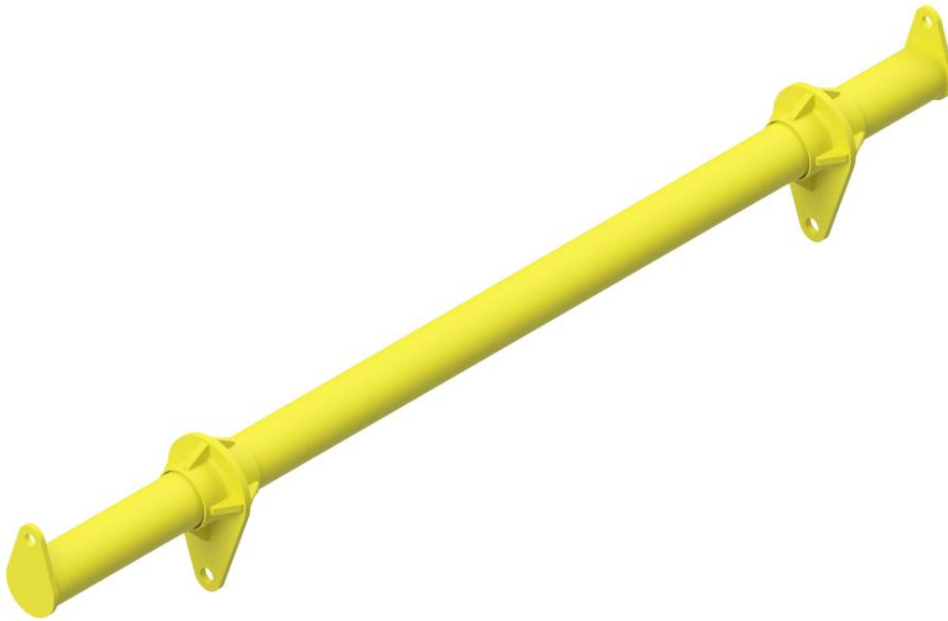

DESCRIPTION

TECHMINE SOLUTION'S ADJUSTABLE LIFTING BEAMS ARE ENGINEERED TO ENSURE CONVEYOR BELT MAINTENANCE IS SAFE, SIMPLE, AND EFFICIENT. THIS LIFTING BEAM IS EQUIPPED WITH ADJUSTABLE LUGS, PROVIDING A VERSATILE AND INNOVATIVE SOLUTION FOR A WIDE RANGE OF LIFTING APPLICATIONS. THE BEAM IS DESIGNED TO BE INSTALLED ON TOP OF EXISTING TROUGH BEAMS, AND WITH THE AID OF LEVER HOISTS, ALLOWS THE RETURN BELT BEAM TO BE LIFTED WITHOUT THE NEED FOR ADDITIONAL RIGGING TO EXTERNAL STRUCTURES. THIS ALLOWS FOR A SIMPLER AND MORE ERGONOMIC ALTERNATIVE TO CONVENTIONAL METHODS.

GENERAL ASSEMBLY DIMENSIONS

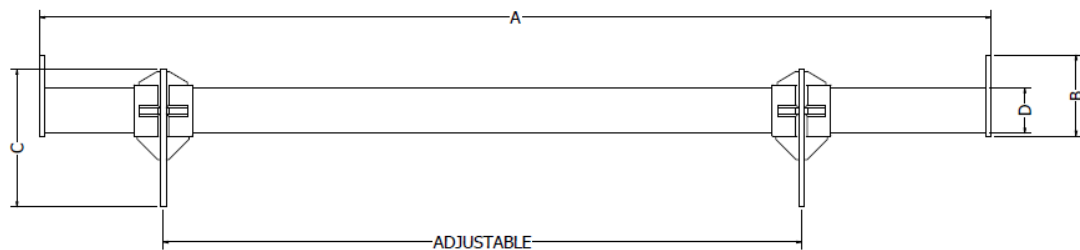

PART NUMBER	DIM A	DIM B	DIM C	DIM D	WEIGHT (KG)
TM-ADJ-1450	1650	159	270	90	6.0
TM-ADJ-1550	1750	159	270	90	6.5
TM-ADJ-1850	2050	159	270	90	8.0
TM-ADJ-2250	2450	159	270	90	10.0
TM-LAP-CUST	CUSTOM	CUSTOM	CUSTOM	CUSTOM	CUSTOM

BELT LIFTER STATION



DESCRIPTION

TECHMINE SOLUTIONS' BELT LIFTER STATION ARE CUSTOM DESIGNED TO EACH INDIVIDUAL APPLICATION AND ALLOWS SPECIFIC BELT LIFTING EQUIPMENT TO BE STORED IN A CONVENIENT AND CENTRALISED LOCATION. THIS REMOVES THE NEED FOR OPERATORS TO MANUALLY TRANSPORT BULKY EQUIPMENT TO EACH LOCATION, PROVIDING A SAFER AND MORE ERGONOMIC SOLUTION TO CONVENTIONAL EQUIPMENT TRANSPORTATION AND STORAGE PROCESSES. THE BESPOKE NATURE OF THE BELT LIFTER STATION MEANS THAT EACH STATION IS CUSTOM DESIGNED TO FIT THE CONVEYOR BELT PROFILE, ALLOWING UNPARALLELED FLEXIBILITY IN ITS LOCATION. EACH BELT LIFTER STATION HAS THE CAPACITY TO STORE, BEAMS SUITED TO THE ADJACENT CONVEYOR, TELESCOPES, PUMPS, CHAINS, SPARE ROLLERS, TOOLBOXES, AND OTHER MISCELLANEOUS EQUIPMENT.

CUSTOM SOLUTIONS

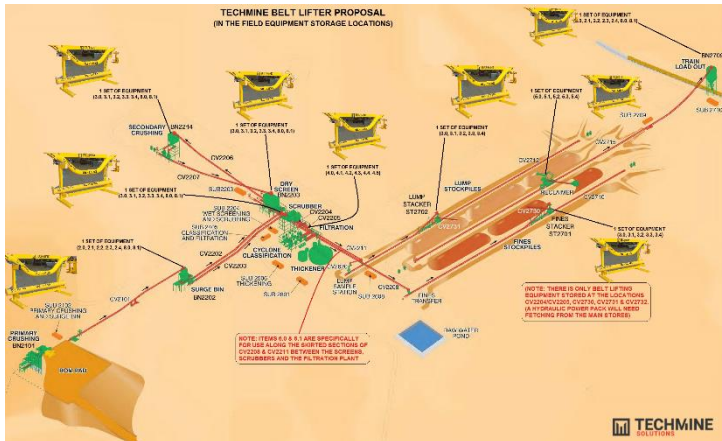

SIMPLY COMPLETE THE QUESTIONNAIRE SHEET AND ATTACH A SITE PLAN AND TECHMINE SOLUTIONS WILL PROPOSE A CUSTOM SOLUTION FOR YOUR SPECIFIC NEEDS AND APPLICATION. BELT LIFTER STATIONS CAN BE LOCATED AT HEAD END, MID-SECTION, OR TAIL END OF THE CONVEYOR BELT.

EQUIPMENT ORIENTATION

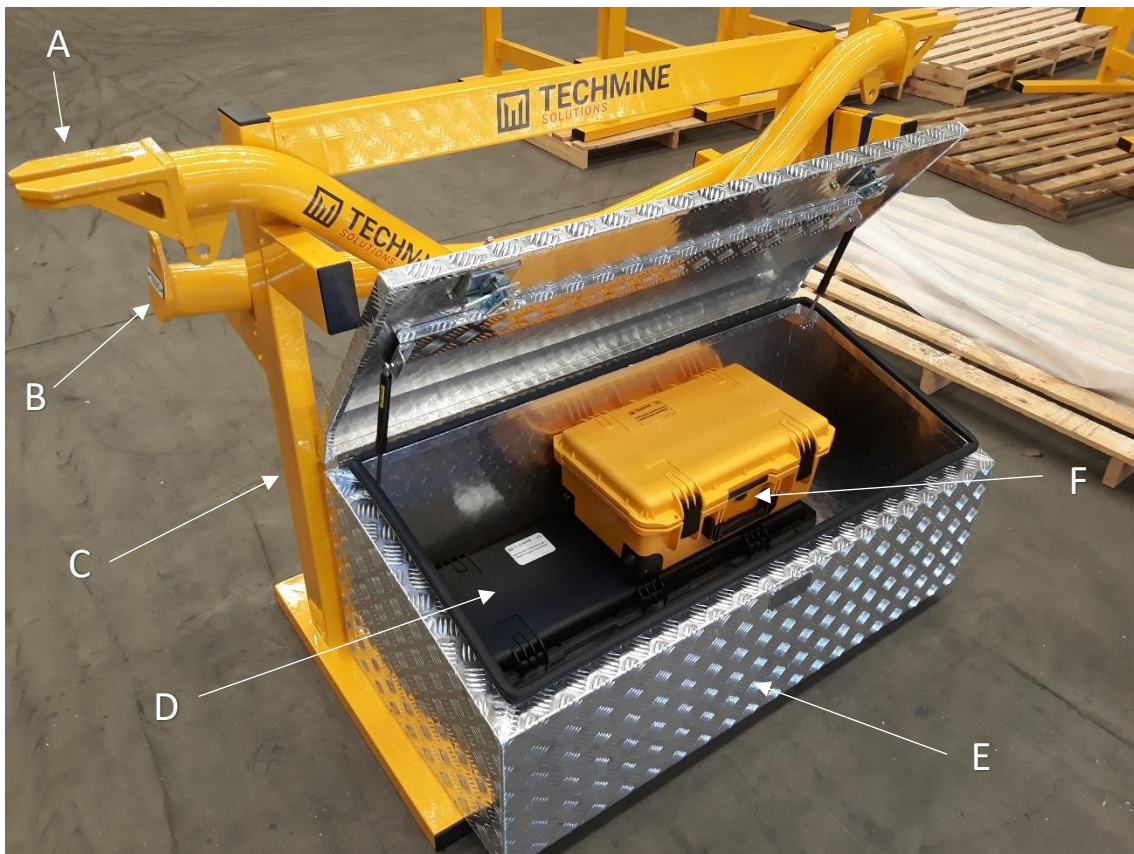

REFERENCE	PART NUMBER	DESCRIPTION
A	TM-XTB****	TROUGH LIFTING BEAM
B	TM-XVB****	V-BENT LIFTING BEAM
C	TM-SUPFRAME	SUPPORT FRAME FOR LIFTING BEAMS
D	TM-BM-CYLL	HYDRAULIC TELESCOPES
E	TM-TOOL	STORAGE TOOLBOX
F	TM-HPU***	HYDRAULIC POWER PACK

IMPACT FRAME PIN PULLER



DESCRIPTION

TECHMINE SOLUTIONS' INDUSTRIAL GRADE IMPACT FRAME PIN PULLER IS ENGINEERED FOR SAFE AND EFFICIENT REMOVAL OF IMPACT FRAME LOCKING PINS. ITS UNIQUE TWO STAGE DESIGN PROVIDES MAXIMUM LEVERAGE DURING THE PIN REMOVAL PROCESS. COMBINED WITH ITS HYDRAULIC POWERED OPERATION, THIS PIN REMOVING TOOL PROVIDES A SAFER AND MORE ERGONOMIC ALTERNATIVE TO TRADITIONAL PIN REMOVING METHODS. THIS COULD POTENTIALLY LEAD TO A SIMULTANEOUS REDUCTION IN BOTH RISK TO WORKERS AND DAMAGE TO EQUIPMENT. THIS PIN PULLER CAN ALSO BE USED TO KNOCK IDLERS FROM ITS SEAT.

MODELS

PART NUMBER	MIN TIP CLEARANCE	MAXIMUM SPREAD	WEIGHT
TM-PP	-	-	-

ANTI-SLIP HYDRAULIC FOOT



DESCRIPTION

TECHMINE SOLUTIONS' ANTI-SLIP HYDRAULIC FOOT PROVIDES AN INNOVATIVE SOLUTION TO THE TRADITIONALLY DIFFICULT AND PROBLEMATIC TASK OF PERFORMING A CONVEYOR BELT LIFT ON AN INCLINE. EQUIPPED WITH FOUR CLAMPING SCREWS, THE ANTI-SLIP HYDRAULIC FOOT ALLOWS THE HYDRAULIC TELESCOPE TO BE SAFELY SECURED TO THE CONVEYOR STRINGER. THIS RESTRICTS LATERAL MOVEMENT OF THE HYDRAULIC FOOT DURING INCLINE CONVEYOR LIFTS, INCREASING STABILITY AND POTENTIALLY RESULTING IN MARKED IMPROVEMENTS TO OPERATOR SAFETY.

CUSTOM SOLUTIONS

ENGINEERED SOLUTIONS FOR YOUR MOST CHALLENGING AND COMPLEX PROBLEMS, THAT'S TECHMINE SOLUTIONS' SPECIALTY. OUR TEAM OF IN-HOUSE ENGINEERS HAVE UNPARALLELED EXPERIENCE IN PROVIDING CONCEPT-TO-COMPLETION SOLUTIONS TO A WIDE RANGE OF PROBLEMS FACED BY THE RESOURCES INDUSTRY. WE TAKE PRIDE IN DEVELOPING INNOVATIVE SOLUTIONS THAT ENHANCES THE SAFETY, SIMPLICITY, AND EFFICIENCY OF CURRENT PROCESSES, EMBODYING OUR VISION OF "WORKING SMARTER NOT HARDER".

PREVIOUS COMMISIONS

MECHANICAL LIFTER SHOE PACKER

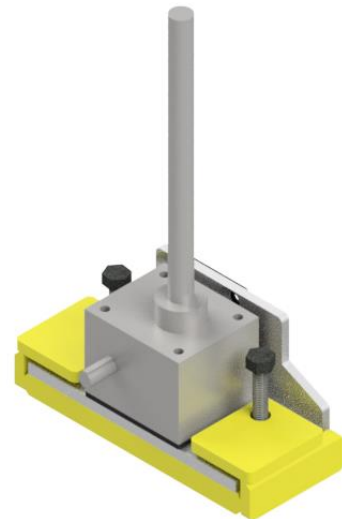

HOOK OVER BRACKETS

**WORK
PLATFORM**

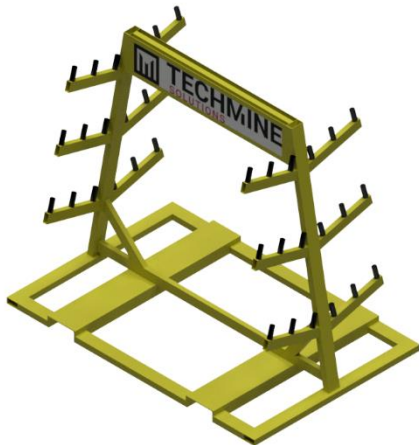

**BEAM
MOUNTING
PLATFORM**

**WALKWAY
IDLER
RETAINER**

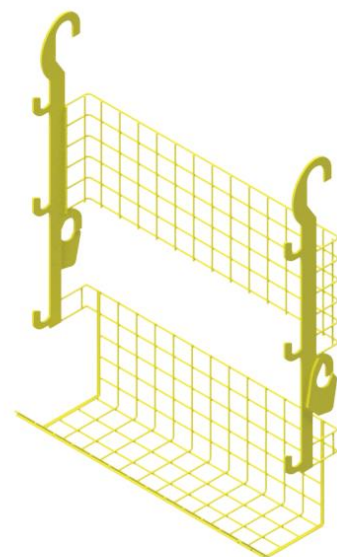

CONTACT US



Marcem Rentals are your North American
Techmine Distributor and Rental Partner.

Contact us today:

E: sales@marcem.ca Ph: +1 (825) 216-0382



08 9303 9564



info@techmine.com.au



www.techmine.com.au